

# Plat of Survey

of

## Lot 10, 11, and the South 10 feet of Lot 12 of Lake Geneva Knoll,

a subdivision recorded October 20, 1926 in Vol. 9 of Plats of Walworth County on Page 70 as Document Number 259528 and located in the Southeast 1/4 of the Southwest 1/4 of Section 33, Town 2 North, Range 17 East, Town of Geneva, Walworth County, Wisconsin.

Surveyed for: **Watts Investments LLC**  
P.O. Box 545  
Williams Bay, Wisconsin. 53191

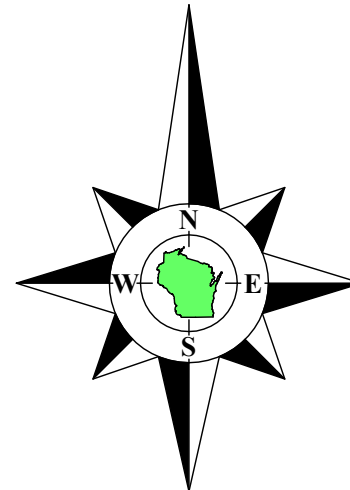

Bearings referenced to the East line of the Southwest 1/4 of Section 33-2-17, recorded as N1°09'12"W in the Wisconsin State Plane Coordinate System, South Zone, (NAD-27).

Coordinates are referenced to the Wisconsin State Plane Coordinate System, South Zone, (NAD-27).

**Bublitz Road**  
(East Court)  
(40' Wide)

**Chapin Road**

**Ravine Drive**  
(Width Varies)

I hereby certify that I have surveyed the above described property in compliance with Chapter A-E 7 of the Wisconsin Administrative Code and that the map hereon is correct to the best of my professional knowledge and belief and shows the size and location of the property, its exterior boundaries, the location and dimensions of all visible structures thereon, boundary fences, apparent easements and roadways and visible encroachments, if any.

This survey is made for the exclusive use of the present owners of the property, and also those who purchase, mortgage or guarantee title thereto, within one year from the date hereof.

Douglas G. Olson  
Wisconsin Professional Land Surveyor - 2093

### Notes:

- This Plat of Survey is not certified unless signed and sealed in red ink.
- This survey is subject to Wisconsin lien laws. This Plat of Survey is the notice of intent to file lien. Lien waiver required.
- The Survey Date shown on this Plat of Survey is the completion date of the field work.

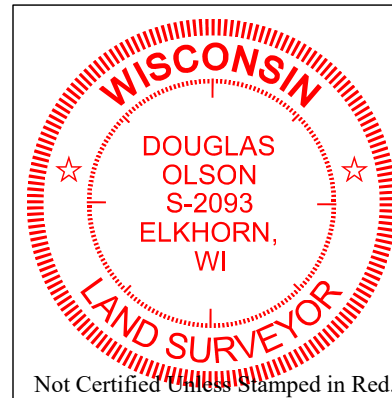

Not Certified Unless Stamped in Red.

Copyright © 2024 by Olson Land Surveying, LLC.

All rights reserved. No part of this survey plat may be reproduced or transmitted in any form by any means - graphic, electronic, or mechanical, including photocopying, tracing, or information storage and retrieval systems - without permission in writing from Douglas G. Olson, Olson Land Surveying, LLC.

### Legend of Symbols & Abbreviations

- Found County Section Corner
  - Found Iron Pipe
  - Found Iron Rod
  - Set Iron Pipe, 1" dia.
  - Recorded Information
  - Utility Pole
  - Utility Box or Pedestal
  - Concrete Cover
  - Concrete Vent
  - Asphalt Surface
  - Concrete Surface
  - Gravel Surface
- N North  
S South  
E East  
W West  
In Bearings  
° Degrees  
' Minutes  
" Seconds  
In Distances  
Feet  
Inches



45 South Wisconsin Street | P.O. Box 322  
Elkhorn, Wisconsin. 53121  
Telephone: (262) 723-3434  
Facsimile: (262) 723-8044  
Email: doug@olsonsurveying.com  
Website: www.olsonsurveying.com

Scale in Feet  
1" = 20'

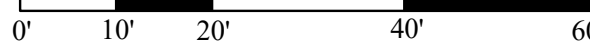

Survey Date: November 19, 2024.  
Revisions: No. 1 - Proposed House Addition & Zoning Info.

2024.140

Sheet 1 of 1 Sheets

Drawing Name:

Job Reference Number  
**2024.140**