

of

a subdivision recorded May 1, 1926 in Vol. 8 of Plats on Page 58 as Document No. 255832 and located in the Northeast 1/4 and the Southeast 1/4 of the Southeast 1/4 of Section 22, Town 2 North, Range 17 East, Town of Geneva, Walworth County, Wisconsin.

Revisions:

Scale in Feet
1" = 20'



A horizontal graphic scale bar with alternating black and white segments. The segments are labeled with their corresponding lengths in feet: 0', 10', 20', 40', and 60'.

45 South Wisconsin Street | P.O. Box 322
Elkhorn, Wisconsin. 53121
Telephone: (262) 723-3434
Facsimile: (262) 723-8044
Email: doug@olsonsurveying.com
Website: www.olsonsurveying.com



OLSON
LAND SURVEYING, LLC

Rural | Residential | Commercial

L.S. SYMBOLS		SYMBOLS & ABBREVIATIONS	
Ø	Found Iron Pipe	N	North
○	Set Iron Pipe, 1" dia.	NE	North East
○	Recorded Information	E	East
○	Utility Pole	W	West
○	Utility Pedestal		In Bearings
○	Fire Hydrant		" Meters
○	Water Valve		" Seconds
○	Manhole		" Distances
○	Polled Surface		Feet
○	Gravel Surface		" inches
○	Concrete Surface		

Sheet 1 of 1 Sheets

Drawing Name:

Job Reference Number
2024.109

2024.109

- 1) This Plat of Survey is not certified unless signed and sealed in red ink.
- 2) This survey is subject to Wisconsin lien laws. This Plat of Survey is the notice of intent to file lien. Lien waiver required.
- 3) The Survey Date shown on this Plat of Survey is the completion date of the field work.

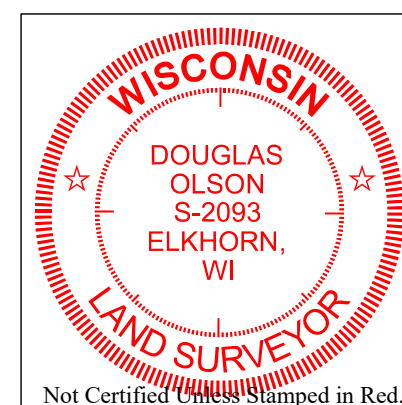

All rights reserved. No part of this survey plat may be reproduced or transmitted in any form by any means - graphic, electronic, or mechanical, including photocopying, tracing, or information storage and retrieval systems - without permission in writing from Douglas G. Olson, Olson Land Surveying, LLC.

I hereby certify that I have surveyed the above described property in compliance with Chapter A-E 7 of the Wisconsin Administrative Code and that the map hereon is correct to the best of my professional knowledge and belief and shows the size and location of the property, its exterior boundaries, the location and dimensions of all visible structures thereon, boundary fences, apparent easements and roadways and visible encroachments, if any.

This survey is made for the exclusive use of the present owners of the property, and also those who purchase, mortgage or guarantee title thereto, within one year from the date hereof.

Douglas G. Olson
Wisconsin Professional Land Surveyor - 2093