

Plat of Survey

of

Lot 1 of Certified Survey Map No. 3843,

recorded September 28, 2005 in Vol. 23 of Certified Survey Maps of Walworth County on Page 179 as Document Number 654922 and located in the Southwest 1/4 of the Southwest 1/4 of Section 16, Town 2 North, Range 17 East, Town of Geneva, Walworth County, Wisconsin.

Surveyed for: **Compass**
751 Geneva Parkway N.
Lake Geneva, Wisconsin. 53147

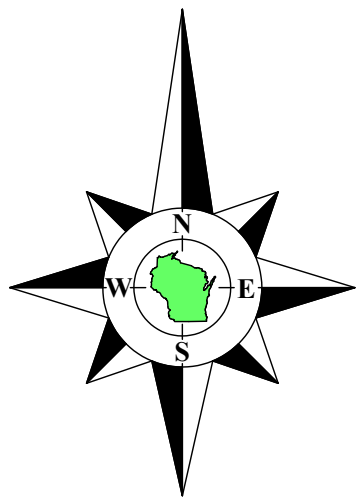

Bearings referenced to the West line of the Southwest 1/4 of Section 16-2-17, recorded as N0°50'31"W in the Wisconsin State Plane Coordinate System, South Zone, (NAD-27).

Coordinates are referenced to the Wisconsin State Plane Coordinate System, South Zone, (NAD-27).

Note 3: Highway H R.O.W.
As Shown on Certified Survey Map No. 3843
R.O.W. information shown is based upon a Conveyance of Land for Highway Purposes to Walworth County, Wisconsin recorded in Vol. 283 of Deeds on Page 487 dated October 30, 1941. Since that time U.S.H. 12 has been built in another location. It appears that this additional highway R.O.W. is an area of questionable ownership.

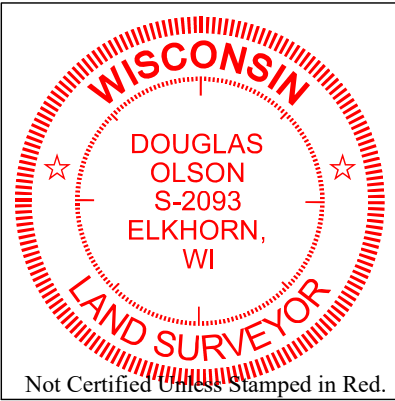

Notes:

- 1) This Plat of Survey is not certified unless signed and sealed in red ink.
- 2) This survey is subject to Wisconsin lien laws. This Plat of Survey is the notice of intent to file lien. Lien waiver required.
- 3) The Survey Date shown on this Plat of Survey is the completion date of the field work.

Copyright © 2024 by Olson Land Surveying, LLC.

All rights reserved. No part of this survey plat may be reproduced or transmitted in any form by any means - graphic, electronic, or mechanical, including photocopying, tracing, or information storage and retrieval systems - without permission in writing from Douglas G. Olson, Olson Land Surveying, LLC.

I hereby certify that I have surveyed the above described property in compliance with Chapter A-E 7 of the Wisconsin Administrative Code and that the map hereon is correct to the best of my professional knowledge and belief and shows the size and location of the property, its exterior boundaries, the location and dimensions of all visible structures thereon, boundary fences, apparent easements and roadways and visible encroachments, if any.

This survey is made for the exclusive use of the present owners of the property, and also those who purchase, mortgage or guarantee title thereto, within one year from the date hereof.

Douglas G. Olson
Wisconsin Professional Land Surveyor - 2093

Survey date: April 5, 2024.
Revisions:

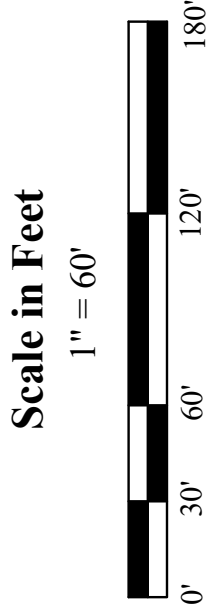

45 South Wisconsin Street | P.O. Box 322
Elkhorn, Wisconsin, 53121
Telephone: (262) 723-3434
Facsimile: (262) 723-8044
Email: doug@olsonsurveying.com
Website: www.olsonsurveying.com



Legend of Symbols & Abbreviations	
Found County Section Corner	Found Iron Rod, etc.
Found Iron Rod, etc.	Recorded Information
Recorded Information	Utility Pole
Utility Pole	Concrete Cover
Concrete Cover	Asphalt Surface
Asphalt Surface	Gravel Surface
Gravel Surface	Brick Pavers

Sheet 1 of 1 Sheets	Job Reference Number 2024.034
Drawing Name	
2024.034	