

Plat of Survey

of

Lots 4 through 10 of Block 24 of Sunset Hills (Unit "B"),

a subdivision recorded August 30, 1926 in Vol. 8 of Plats of Walworth County
on Page 97 as Document Number 258335 and located in the Northeast 1/4 of
the Southwest 1/4 of Section 33, Town 2 North, Range 17 East, Town of
Geneva, Walworth County, Wisconsin.

Surveyed for: **Ed Waddle & Kathy McElmurry**

42220 North Kilbourne Road
Zion, Illinois. 60099

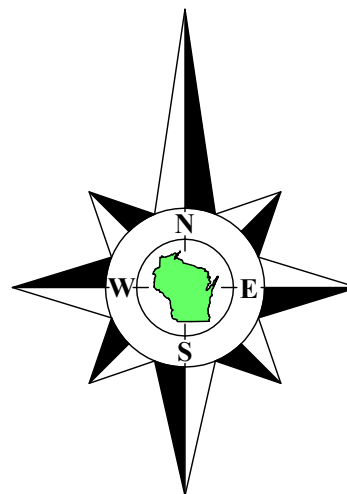

Bearings referenced to the North line of the Southwest 1/4 of Section 33-2-17,
recorded as N88°52'35"E in the Wisconsin State Plane Coordinate System,
South Zone, (NAD-27).

Coordinates are referenced to the Wisconsin State
Plane Coordinate System, South Zone, (NAD-27).

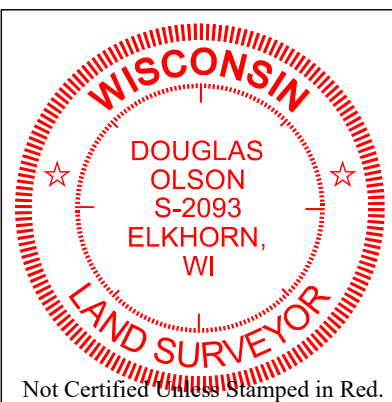

Notes:

- 1) This Plat of Survey is not certified unless signed and sealed in red ink.
- 2) This survey is subject to Wisconsin lien laws. This Plat of Survey is the notice of intent to file lien. Lien waiver required.
- 3) The Survey Date shown on this Plat of Survey is the completion date of the field work.

Copyright ©2024 by Olson Land Surveying, LLC.

All rights reserved. No part of this survey plat may be reproduced or transmitted in any form by any means - graphic, electronic, or mechanical, including photocopying, tracing, or information storage and retrieval systems - without permission in writing from Douglas G. Olson, Olson Land Surveying, LLC.

I hereby certify that I have surveyed the above described property in compliance with Chapter A-E 7 of the Wisconsin Administrative Code and that the map hereon is correct to the best of my professional knowledge and belief and shows the size and location of the property, its exterior boundaries, the location and dimensions of all visible structures thereon, boundary fences, apparent easements and roadways and visible encroachments, if any.

This survey is made for the exclusive use of the present owners of the property, and also those who purchase, mortgage or guarantee title thereto, within one year from the date hereof.

Douglas G. Olson
Wisconsin Professional Land Surveyor - 2093