

LAND-MARK SURVEYING

Mark L. Miritz

Wisconsin Professional Land Surveyor S-2582

N9330 Knuteson Drive
Whitewater, WI 53190
Phone: (262) 949-1239
MARKMIRITZ@
LAND-MARKSURVEYING.COM

PLAT OF SURVEY

LOT 3 OF CERTIFIED SURVEY MAP NO. 5001, RECORDED AS DOCUMENT NO. 1053409 IN WALWORTH COUNTY RECORDS, LOCATED IN PART OF THE NORTHWEST 1/4 OF THE SOUTHEAST 1/4 AND PART OF THE SOUTHWEST 1/4 OF THE SOUTHEAST 1/4 OF SECTION 13 AND PART OF THE NORTHWEST 1/4 OF THE NORTHEAST 1/4 OF SECTION 24, ALL IN TOWN 2 NORTH, RANGE 17 EAST, TOWN OF GENEVA, WALWORTH COUNTY, WISCONSIN.

OWNER:
SALVATORE J. DIMICELI SR TRUST
101 BROAD ST., SUITE 207
LAKE GENEVA, WI 53147

Horizontal Datum is based on the Wisconsin State Plane Coordinate System GFD, South Zone, North American Datum of 1983/2011, the WEST LINE of SE 1/4 Sec. 13-2-17 assumed N 01°01'45" W

VERTICAL DATUM OF 1988 (12)

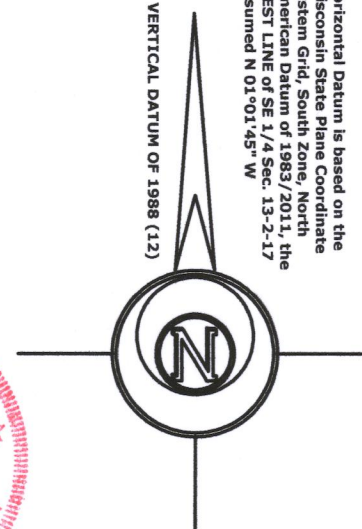

LEGEND

WOODED AREA

INGRESS & EGRESS EASEMENT

- FOUND IRON ROD 1 1/4"
- FOUND IRON ROD 3/4"
- (x x) RECORDED AS DIMENSION

SCALE: 1 INCH = 80 FEET

"I hereby certify that the above described property has been surveyed by me or under my direction and that the above map is a true representation thereof and shows the size and location of the property, its exterior boundaries, the location of all visible structures and dimensions of all principal buildings thereon, boundary fences, apparent easements, roadways and visible encroachments, if any." "This survey is made for the use of the present owners of the property, and also those who purchase, mortgage, or guarantee the title thereto within one year from date hereof."

Mark L. Miritz
MARK L. MIRITZ
WISCONSIN PROFESSIONAL
LAND SURVEYOR S-2582

DATE: FEB. 16, 2022 JOB NO. 20.907

TRINITY MOUNTAIN ESTATES

LOT 3
345,772 SQ. FT.
7.94 ACRES

12' WIDE ELECTRIC, GAS & COMMUNICATION EASEMENT
DOCUMENT NO. 588741

EXISTING BLACKTOP

SOIL BORINGS

LOT 20

TRINITY LANE
PRIVATE ROAD 66' WIDE

OUTLOT 5

PUMP HOUSE EASEMENT

LOT 2

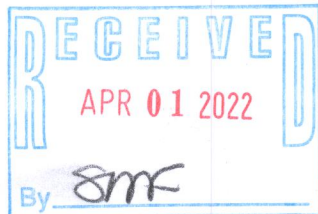

JA5001-3

217-5910