

PLAT OF SURVEY

A PARCEL OF LAND LOCATED IN THE NORTHEAST 1/4 OF THE NORTHEAST 1/4 OF SECTION 30 IN TOWNSHIP 2 NORTH, RANGE 17 EAST, IN THE TOWN OF GENEVA, WALWORTH COUNTY, WISCONSIN.

LEGEND

- FOUND IRON ROD
- (XX) RECORDED AS
- EXISTING CONCRETE
- EXISTING ASPHALT DRIVE
- EXISTING BUILDING
- TRANSFORMER
- UTILITY PEDESTAL



0 30 60 Feet

SCALE: 1"=30'

NOTE:

1. BASIS OF BEARING: THE WISCONSIN STATE PLANE COORDINATE SYSTEM, NAD-83, SOUTH ZONE.
2. FIELD WORK COMPLETED JANUARY 7, 2020
3. BUILDING SURVEYED TO THE EXTERIOR OF SIDING.
4. FIELD CREW CHIEF: LOGAN RANDLE

LEGAL DESCRIPTION:

A PARCEL OF LAND LOCATED IN THE NORTHEAST 1/4 OF THE NORTHEAST 1/4 OF SECTION 30 IN TOWNSHIP 2 NORTH, RANGE 17 EAST, IN THE TOWN OF GENEVA, WALWORTH COUNTY, WISCONSIN, MORE PARTICULARLY DESCRIBED AS:

UNIT 11-16 IN GENEVA NATIONAL CONDOMINIUM NO. 11, AS RECORDED IN DOC # 194629 AT THE WALWORTH COUNTY REGISTER OF DEEDS.

SURVEY ORDERED BY:

CHRIS HUMPHREYS

PROPERTY ADDRESS:

1760 AVENUE OF CHAMPIONS
LAKE GENEVA, WI 53147

SURVEYOR:

PAUL H. VAN HENKELUM, PLS
CARDINAL ENGINEERING LLC

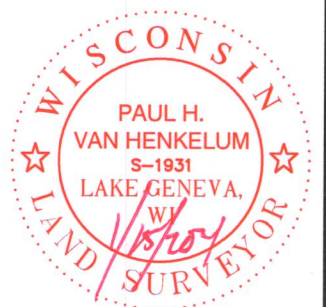

"I HEREBY CERTIFY THAT I HAVE SURVEYED THE ABOVE DESCRIBED PROPERTY AND THE MAP IS A TRUE AND CORRECT REPRESENTATION OF ITS EXTERIOR BOUNDARIES AND SHOWS THE SIZE AND LOCATION OF ALL VISIBLE STRUCTURES, APPARENT EASEMENTS AND ENCROACHMENTS, IF ANY."

Paul H. Van Henkelum
PAUL H VAN HENKELUM, PLS #1931

1/15/2021
DATE

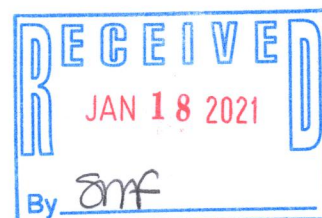

UNIT 11-15
GENEVA NATIONAL
CONDO.

N79° 31' 45"W 237.91'
(N79° 33' 23"W 238.00')

R=433.00' L=80.01'
Ch=S15° 39' 09"W 79.89'
(R=433.00' L=80.00'
Ch=S15° 44' 11"W 79.886')

AVENUE OF CHAMPIONS 66' R/W

UNIT 11-17
GENEVA NATIONAL
CONDO.

(N68° 58' 14"W 274.82')
S68° 58' 08"E 214.93'

UNIT 11-16
GENEVA NATIONAL
CONDO.

EXISTING
BUILDING

UNIT 11-14
GENEVA NATIONAL
CONDO.

GOLF CLUB GROUNDS

JGN 11-16

217-479