

Northwest Corner
Section 29-2-17
N. 226,566.83
E. 2,397,976.42

Plat of Survey

of

Unit 19-34 of Geneva National Condominium No. 19,

located in the Northeast 1/4 of the Northwest 1/4 of Section 29, Town 2 North,
Range 17 East, Town of Geneva, Walworth County, Wisconsin.

Surveyed for: **Keefe Real Estate, Inc.**

751 Geneva Parkway
Lake Geneva, Wisconsin. 53147

Survey Date: March 20, 2020.
Revisions:

Scale in Feet
1" = 20'



45 South Wisconsin Street | P.O. Box 322
Elkhorn, Wisconsin 53121
Telephone: (262) 723-3434
Facsimile: (262) 723-8044
Email: doug@olsonsurveying.com
Website: www.olsonsurveying.com

OLSON
LAND SURVEYING, LLC
Rural | Residential | Commercial

Legend of Symbols & Abbreviations

North	N	North	North
South	S	South	South
East	E	East	East
West	W	West	West
Found County Section Corner	●	Found County Section Corner	●
Found Iron Rod with PFA cap	○	Found Iron Rod with PFA cap	○
Found Iron Rod with no cap	○	Found Iron Rod with no cap	○
Set Iron Pipe, 1" dia.	○	Set Iron Pipe, 1" dia.	○
Recorded Information	○	Recorded Information	○
Fire Hydrant	○	Fire Hydrant	○
Utility Pedestal	○	Utility Pedestal	○
Manhole	○	Manhole	○
Asphalt Surface	○	Asphalt Surface	○
Concrete Surface	○	Concrete Surface	○

Sheet 1 of 1 Sheets
Drawing Name
Job Reference Number
2020.022

2020.022

S82°49'31"E 1276.67'

Prestwick Drive

(66' Wide)

Culvert

Brushy

Unit 19-34

Tax Parcel
JGN 1900034

0.440 Acre
19,174 Sq.Ft.

Unit 19-33

Unit 19-35

Brushy

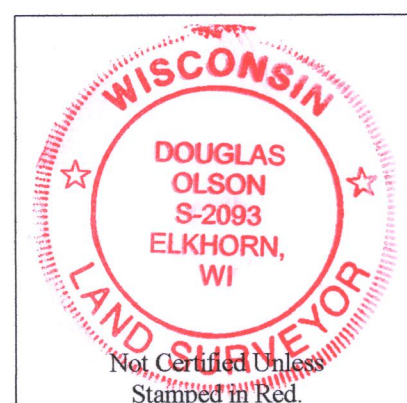

Notes:

- 1) This Plat of Survey is not certified unless signed and sealed in red ink.
- 2) This survey is subject to Wisconsin lien laws. This Plat of Survey is the notice of intent to file lien. Lien waiver required.
- 3) The Survey Date shown on this Plat of Survey is the completion date of the field work.

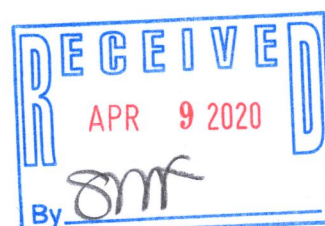

N12°30'58"W 146.50'
recorded as(N12°30'58"W 146.53')

Edge of Mown Lawn

Edge of Brush

PVC Drain
Pipe Outlet

Landscaped Area
With Bushes

Root

Small Water
Feature

Unit 19-32

S57°26'28"W 78.51'
recorded as(S57°26'51"W 78.60')

S30°05'24"W 149.08'
recorded as(S30°06'55"W 149.00')



Bearings referenced to the North line of the Northwest 1/4 of Section 29-2-17,
recorded as N88°49'11"E in the Wisconsin State Plane Coordinate System,
South Zone, (NAD-27).

Coordinates are referenced to the Wisconsin State
Plane Coordinate System, South Zone, (NAD-27).

Copyright ©2020 by Olson Land Surveying, LLC.

All rights reserved. No part of this survey plat may be reproduced or transmitted in
any form by any means - graphic, electronic, or mechanical, including photocopying,
tracing, or information storage and retrieval systems - without permission in writing
from Douglas G. Olson, Olson Land Surveying, LLC.

I hereby certify that I have surveyed the above described property in compliance
with Chapter A-E 7 of the Wisconsin Administrative Code and that the map hereon is
correct to the best of my professional knowledge and belief and shows the size and
location of the property, its exterior boundaries, the location and dimensions of all
visible structures thereon, boundary fences, apparent easements and roadways and
visible encroachments, if any.

This survey is made for the exclusive use of the present owners of the property,
and also those who purchase, mortgage or guarantee title thereto, within one year from
the date hereof.

Douglas G. Olson
Wisconsin Professional Land Surveyor - 2093

JGN 19-34

217-4627