

N89°49'05"E 66.02'
recorded as(N89°59'E 86.00')

Concrete Monument
leaning 0.4' S. of line.
Set Straight 05-15-2019.

N89°59'08"E 192.96'
recorded as(N89°59'E 193.13')

Plat of Survey

of

Lot 18 in Tract One of Geneva Bay Estates,

a subdivision located in Government Lot 3 in the Southwest 1/4 of Section 35,
Town 2 North, Range 17 East, Town of Geneva, Walworth County, Wisconsin.

Surveyed for: **@properties**
880 West Main Street
Lake Geneva, Wisconsin. 53147

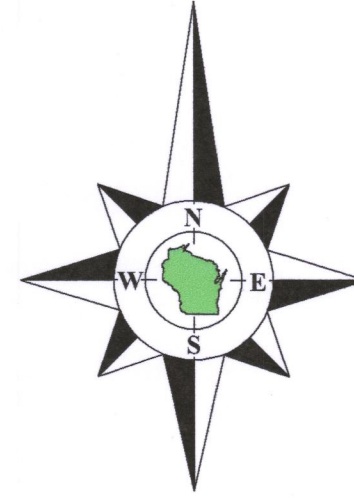

Bearings referenced to the long chord bearing of the
curve on the Northerly line of Geneva Bay Drive,
recorded as S52°24'E on the plat of Geneva Bay Estates.

recorded as(N7°49'W 127.53')
N7°47'29"W 126.98'

Lot 17

recorded as(S87°02'E 210.80')
S87°00'11"E 210.58'

Lot 1
C.S.M. 958

S7°42'05"E 115.57'
recorded as(N7°49'W 115.75')

Lot 18
Tax Parcel
JGBE 00018
0.734 Acre
31,992 Sq.Ft.

Lot 1
C.S.M. 958

S50°03'52"W 94.38'
recorded as(N50°03'E 95.06')Plat
recorded as(N50°06'15"E 94.51')CSM 958

N62°24'00"W 425.25'
recorded as(N52°24'W 425.65')

Copyright © 2019 by Olson Land Surveying, LLC.

All rights reserved. No part of this survey plat may be reproduced or transmitted in
any form by any means - graphic, electronic, or mechanical, including photocopying,
tracing, or information storage and retrieval systems - without permission in writing
from Douglas G. Olson, Olson Land Surveying, LLC.

I hereby certify that I have surveyed the above described property in compliance
with Chapter A-E 7 of the Wisconsin Administrative Code and that the map hereon is
correct to the best of my professional knowledge and belief and shows the size and
location of the property, its exterior boundaries, the location and dimensions of all
visible structures thereon, boundary fences, apparent easements and roadways and
visible encroachments, if any.

This survey is made for the exclusive use of the present owners of the property,
and also those who purchase, mortgage or guarantee title thereto, within one year from
the date hereof.

Douglas G. Olson
Wisconsin Professional Land Surveyor - 2093

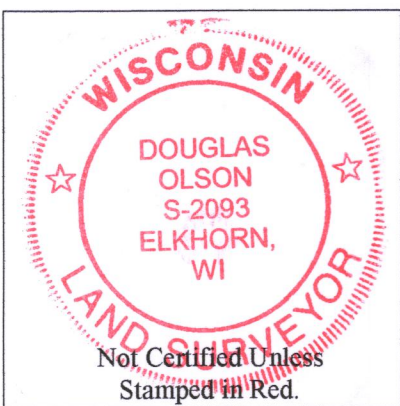

Notes:

- 1) This Plat of Survey is not certified unless signed and sealed in red ink.
- 2) This survey is subject to Wisconsin lien laws. This Plat of Survey is the notice of intent to file lien. Lien waiver required.
- 3) The Survey Date shown on this Plat of Survey is the completion date of the field work.

Sheet 1 of 1 Sheets

Drawing Name:

Job Reference Number
2019.044

Legend of Symbols & Abbreviations

- | | |
|-------------------------|--------------|
| Found Concrete Monument | N North |
| Found Iron Pipe | S South |
| Found Iron Rod | E East |
| Set Cut Cross | W West |
| Recorded Information | In Bearings |
| Utility Pole | " Degrees |
| Utility Box or Pedestal | " Minutes |
| Concrete Cover | " Seconds |
| Asphalt Surface | In Distances |
| Concrete Surface | " Feet |
| | " Inches |



45 South Wisconsin Street | P.O. Box 322
Elkhorn, Wisconsin. 53121
Telephone: (262) 723-3434
Facsimile: (262) 723-8044
Email: doug@olsonsurveying.com
Website: www.olsonsurveying.com

Scale in Feet
1" = 20'



Survey Date: May 2, 2019.

Revisions: No. 1 - Concrete Monument
Set Straight

2019.044

JGBE-18

217-4578