

Plat of Survey

of

Lot 1 of Certified Survey Map No. 1814,

recorded in Vol. 8 of Certified Survey Maps of Walworth County on Page 295 and located in the Northwest 1/4 of the Southwest 1/4 of Section 21, Town 2 North, Range 17 East, Town of Geneva, Walworth County, Wisconsin.

Surveyed for: **Keefe Real Estate, Inc.**

751 Geneva Parkway
Lake Geneva, Wisconsin. 53147



Bearings referenced to the North line of the Southwest 1/4 of Section 21-2-17, recorded as N88°47'18"E in the Wisconsin State Plane Coordinate System, South Zone, (NAD-27).

Tax Parcel
JG 2100006

Lot 1
Tax Parcel
JA181400001

5.001 Acres
217,833 Sq.Ft.
4.792 Acres
208,758 Sq.Ft.
Exclusive of R.O.W.

Tax Parcel
JG 2100007

Notes:

The location of paved or gravel surfaces shown on this plat are approximate due to existing snow cover on the property at the time of the field survey.

There may be additional improvements or encroachments on the property which were not visible at the time of the field survey and are not shown on this plat.

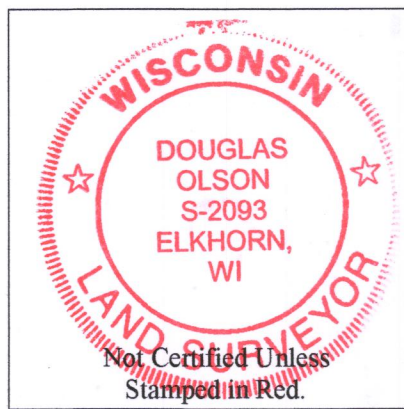

- 1) This Plat of Survey is not certified unless signed and sealed in red ink.
- 2) This survey is subject to Wisconsin lien laws. This Plat of Survey is the notice of intent to file lien. Lien waiver required.
- 3) The Survey Date shown on this Plat of Survey is the completion date of the field work.



Copyright © 2019 by Olson Land Surveying, LLC.

All rights reserved. No part of this survey plat may be reproduced or transmitted in any form by any means - graphic, electronic, or mechanical, including photocopying, tracing, or information storage and retrieval systems - without permission in writing from Douglas G. Olson, Olson Land Surveying, LLC.

I hereby certify that I have surveyed the above described property in compliance with Chapter A-E 7 of the Wisconsin Administrative Code and that the map hereon is correct to the best of my professional knowledge and belief and shows the size and location of the property, its exterior boundaries, the location and dimensions of all visible structures thereon, boundary fences, apparent easements and roadways and visible encroachments, if any.

This survey is made for the exclusive use of the present owners of the property, and also those who purchase, mortgage or guarantee title thereto, within one year from the date hereof.

Douglas G. Olson
Wisconsin Professional Land Surveyor - 2093

Tax Parcel
JG 2100006

Square Concrete Post as shown on survey by Lloyd L. Jensen dated March 1, 1989.

Sheet 1 of 1 Sheets

Drawing Name:

Job Reference Number
2019.015

Legend of Symbols & Abbreviations

- Found County Section Corner
- Found Iron Rod
- Set Iron Pipe, 1" dia.
- Recorded Information
- Utility Pole
- Utility Pedestal
- Concrete Cover
- Asphalt Surface
- Concrete Surface
- Septic Vent

- N North
- S South
- E East
- W West
- In Degrees
- Minutes
- Seconds
- In Distances
- Feet
- Inches



45 South Wisconsin Street | P.O. Box 322
Elkhorn, Wisconsin. 53121
Telephone: (262) 723-3434
Facsimile: (262) 723-8044
Email: doug@olsonsurveying.com
Website: www.olsonsurveying.com

Scale in Feet
1" = 40'



Survey Date: February 14, 2019.

Revisions:

2019.015

JA1814-1 217-4576