

# PLAT OF SURVEY & TOPOGRAPHIC MAPPING UNIT 16-29 GENEVA NATIONAL CONDOMINIUM NO. 16

LOCATED IN PART OF THE NW 1/4 OF THE NE 1/4  
OF SECTION 29, TOWN 2 NORTH, RANGE 17 EAST,  
TOWN OF GENEVA, WALWORTH COUNTY, WISCONSIN

ASSIGNED N.E. LINE OF UNIT 16-29  
S 56°22'35" E

UNIT 16-24

UNIT 16-30

UNIT 16-25

UNIT 16-29  
17,934 SQ. FT.  
(0.41 ACRES)

UNIT 16-26

UNIT 16-38

UNIT 16-28

UNIT 16-39

BENCHMARK: RIM  
SANITARY MANHOLE  
ELEV=1040.95

AS BUILT  
FOUNDATION

BUILDING  
INFORMATION TAKEN  
FROM PETER S.  
GORDON SURVEY  
DATED 03/24/2010

## LEGEND

- = FOUND REBAR STAKE
- ☒ = TELEPHONE BOX
- ☐ = ELECTRIC BOX
- ☐ = CABLE BOX
- ⊗ = WATER VALVE
- ⊕ = SANITARY SEWER MANHOLE
- {XXX} = RECORDED AS
- +XXXX = EXISTING GROUND ELEVATION
- XXXX--- = EXISTING LAND CONTOURS

20 10 0 20 40 60 80  
MAP SCALE IN FEET - ORIGINAL 1"=20'

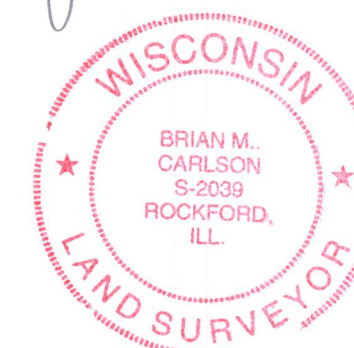
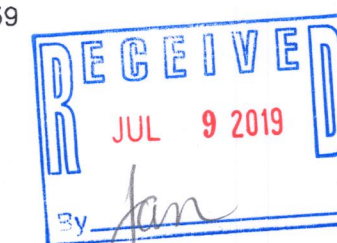

NOTE: COPIES OF THIS MAP TO WHICH THE FOLLOWING CERTIFICATE WILL APPLY SHOW  
THE SURVEYOR'S ORIGINAL SEAL AND SIGNATURE IN RED INK. COPIES BY ANY OTHER  
MEANS MAY HAVE ALTERATIONS WHICH DO NOT REPRESENT THE SURVEYOR'S WORK  
PRODUCT.

I HEREBY CERTIFY THAT THE ABOVE DESCRIBED PROPERTY HAS BEEN SURVEYED  
UNDER MY DIRECTION AND THAT THE ABOVE MAP IS A TRUE REPRESENTATION  
THEREOF AND SHOWS THE SIZE AND LOCATION OF THE PROPERTY AND ITS EXTERIOR  
BOUNDARIES. THIS SURVEY IS MADE FOR THE USE OF THE PRESENT OWNERS OF THE  
PROPERTY, AND ALSO THOSE WHO PURCHASE, MORTGAGE, OR GUARANTEE THE TITLE  
THERE TO WITHIN ONE YEAR FROM THE DATE HEREOF.

DATED: 06/05/2019

BRIAN M. CARLSON P.L.S. 2039

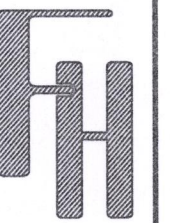

TOPOGRAPHIC SURVEY  
154-1 RYDER CUP ROAD  
LAKE GENEVA, WI 53147

WORK ORDERED BY -  
OMEGA HOMES  
210 E. O'CONNOR DRIVE SUITE 101  
ELKHORN, WI 53121

FARRIS, HANSEN & ASSOCIATES, INC.  
ENGINEERING - ARCHITECTURE - SURVEYING  
7 RIDGWAY COURT P.O. BOX 437  
ELKHORN, WISCONSIN 53121  
OFFICE: (262) 723-2098 FAX: (262) 723-5886

REVISIONS  
06/05/2019 - LB  
TOPG. SURVEY

PROJECT NO.  
3269-16-29

DATE:  
06/05/2019

SHEET NO.  
1 OF 1

X:\PROJECTS\3269\CONDO\_16\UNIT\_29\ACAD\3269-16-29.DWG

JGN 16-29 217-4561