

"PRESERVED WOODLANDS"

Lot 8
Tax Parcel
JTR 00008
4.001 Acres
174,292 Sq.Ft.

Plat of Survey

of

Lot 8 of Trinity Mountain Estates,
a subdivision located in the Southwest 1/4 of the Southeast 1/4 of Section 13,
Town 2 North, Range 17 East, Town of Geneva, Walworth County, Wisconsin.

Surveyed for: **Fred & Dhana Cohen**
1061 Rosemary Terrace
Deerfield, Illinois. 60015

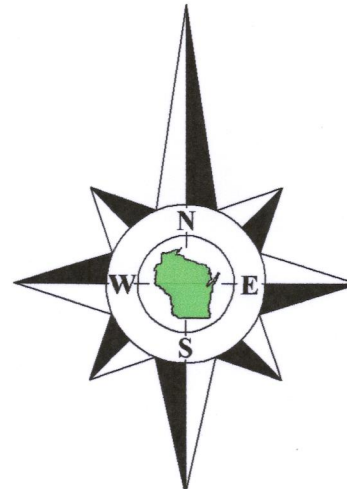

Bearings referenced to the West line of Lot 8, recorded
as N2°46'36"W on the plat of Trinity Mountain Estates.

Lot 9

Lot 7

Outlot 4
Summit Drive
(66' Wide)

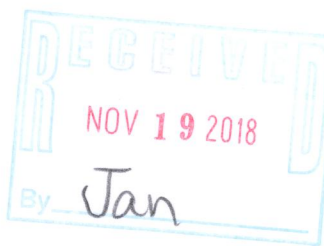

Copyright © 2018 by Olson Land Surveying, LLC.

All rights reserved. No part of this survey plat may be reproduced or transmitted in any form by any means - graphic, electronic, or mechanical, including photocopying, tracing, or information storage and retrieval systems - without permission in writing from Douglas G. Olson, Olson Land Surveying, LLC.

I hereby certify that I have surveyed the above described property in compliance with Chapter A-E 7 of the Wisconsin Administrative Code and that the map hereon is correct to the best of my professional knowledge and belief and shows the size and location of the property, its exterior boundaries, the location and dimensions of all visible structures thereon, boundary fences, apparent easements and roadways and visible encroachments, if any.
This survey is made for the exclusive use of the present owners of the property, and also those who purchase, mortgage or guarantee title thereto, within one year from the date hereof.

Douglas G. Olson
Wisconsin Professional Land Surveyor - 2093

Notes:

- 1) This Plat of Survey is not certified unless signed and sealed in red ink.
- 2) This survey is subject to Wisconsin lien laws. This Plat of Survey is the notice of intent to file lien. Lien waiver required.
- 3) The Survey Date shown on this Plat of Survey is the completion date of the field work.

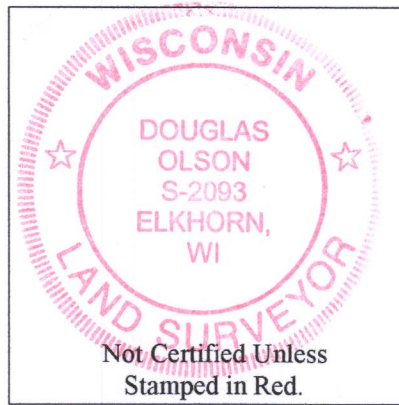

Legend of Symbols & Abbreviations

- Found County Section Corner
- Found Iron Rod, 1-3/4" dia.
- Found Iron Rod, 3/4" dia.
- Set Wood Lath
- Recorded Information
- Utility Box or Pedestal
- Septic Vent
- Asphalt Surface
- Large Boulder

- N North
- S South
- E East
- W West
- Bearings
- Distances
- Minutes
- Seconds
- Feet
- Inches



45 South Wisconsin Street | P.O. Box 322
Elkhorn, Wisconsin. 53121
Telephone: (262) 723-3434
Facsimile: (262) 723-8044
Email: doug@olsonsurveying.com
Website: www.olsonsurveying.com

Scale in Feet
1" = 20'



Survey date: May 15, 2018.
Revisions: No. 1 - Topography
No. 2 - 1"=20'

Sheet 1 of 1 Sheets

Drawing Name:

Job Reference Number
2018.049

2018.049

JTR-8

917-4493