

PLAT OF SURVEY UNIT 19-08

GENEVA NATIONAL CONDOMINIUM NO. 19
LOCATED IN TOWN 2 NORTH, RANGE 17 EAST
WALWORTH COUNTY, WISCONSIN

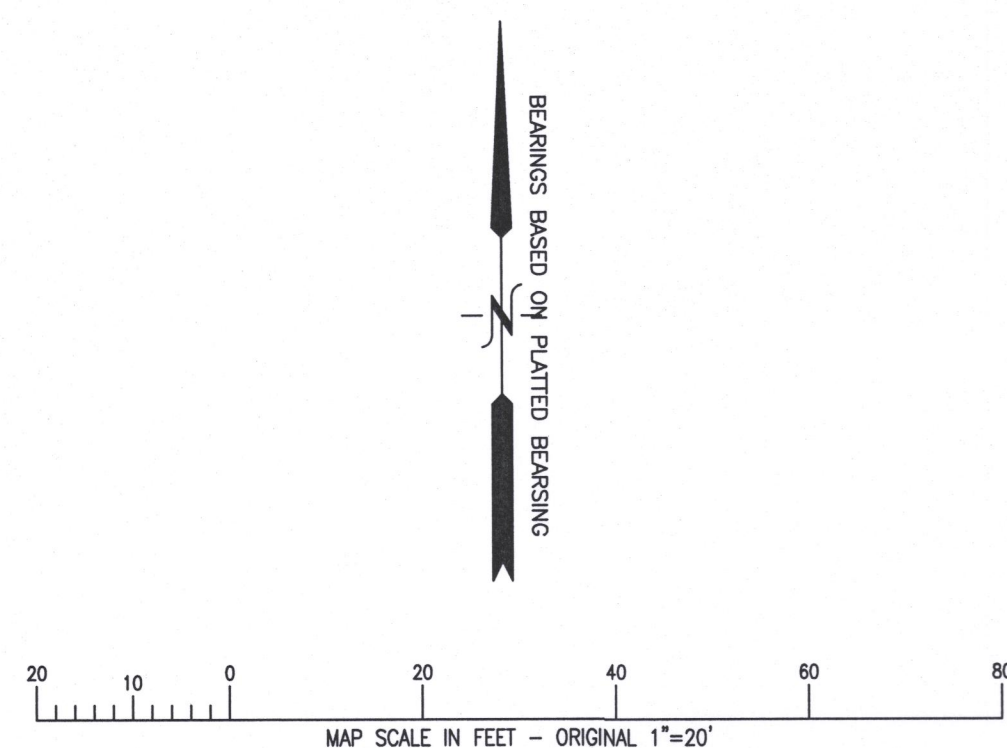

UNIT 19-07

UNIT 19-08
26,193 S.F.

UNIT 19-10

UNIT 19-09

GOLF CLUB GROUNDS

DRAINAGEWAY

50' REAR YARD SETBACK

210.13
{210.28}
N 54°41'32" E
10' SIDE YARD SETBACK

91.82'
{92.00}
S 64°12'12" E

S 25°47'48" W
{118.72}
{118.60}

10' SIDE YARD

S 76°26'07" W
177.29'
10' SIDE YARD SETBACK

36.7'
12.0'
12.0'
14.1'

BRICK
32.4'

CONCRETE DRIVEWAY
25' STREET YARD SETBACK
N 24°26'10" W
C=13.56
R=195.00

PRESTWICK DRIVE
8" WATERMAIN
8" SANITARY SEWER
EDGE OF PAVEMENT

- LEGEND
- = FOUND IRON PIPE STAKE, 1 3/8" O.D.
 - = FOUND IRON REBAR STAKE, 3/4" DIA.
 - {xxx} = RECORDED AS

NOTE: COPIES OF THIS MAP TO WHICH THE FOLLOWING CERTIFICATE WILL APPLY SHOW THE SURVEYOR'S ORIGINAL SEAL AND SIGNATURE IN RED INK. COPIES BY ANY OTHER MEANS MAY HAVE ALTERATIONS WHICH DO NOT REPRESENT THE SURVEYOR'S WORK PRODUCT.

I HEREBY CERTIFY THAT THE ABOVE DESCRIBED PROPERTY HAS BEEN SURVEYED UNDER MY DIRECTION AND THAT THE ABOVE MAP IS A TRUE REPRESENTATION THEREOF AND SHOWS THE SIZE AND LOCATION OF THE PROPERTY AND ITS EXTERIOR BOUNDARIES. THIS SURVEY IS MADE FOR THE USE OF THE PRESENT OWNERS OF THE PROPERTY, AND ALSO THOSE WHO PURCHASE, MORTGAGE, OR GUARANTEE THE TITLE THERETO WITHIN ONE YEAR FROM THE DATE HEREOF.

DATED: 4/23/2018

Brian M. Carlson
BRIAN M. CARLSON P.L.S. 2039

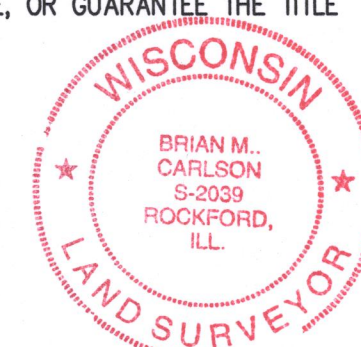

WORK ORDERED BY -
KATRINA D BRULEY
8777 PEBBLE CREEK LANE
SARASOTA, FL 34238

FARRIS, HANSEN & ASSOCIATES, INC.
ENGINEERING - ARCHITECTURE - SURVEYING
7 RIDGWAY COURT P.O. BOX 437
ELKHORN, WISCONSIN 53121
OFFICE: (262) 723-2098 FAX: (262) 723-5886

REVISIONS

PROJECT NO.
3269.19.08.18
DATE:
4/20/2018
SHEET NO.
1 OF 1