

Meander Corner
Section 32-2-17
N. 218,715.05
E. 2,402,991.69

recorded as(S89°09'34"W 448.48')
S89°09'34"W 448.40'
North line of the Southeast 1/4 of Section 32-2-17

East 1/4 Corner
Section 32-2-17
N. 218,721.63
E. 2,403,440.12

Plat of Survey

of
Lots 3 & 4 of Como-Vista Subdivision,
located in the Government Lot 5 in the Southeast 1/4 of Section 32, Town
2 North, Range 17 East, Town of Geneva, Walworth County, Wisconsin.

Surveyed for: **Shorewest Realtors**
623 Main Street
Lake Geneva, Wisconsin. 53147



Bearings referenced to the North line of the Southeast 1/4 of Section 32-2-17,
recorded as S89°09'34"W in the Wisconsin State Plane Coordinate System,
South Zone, (NAD-27).
Coordinates are referenced to the Wisconsin State
Plane Coordinate System, South Zone, (NAD-27).

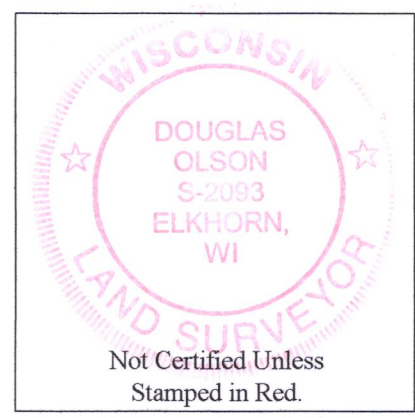

- Notes:**
- 1) This Plat of Survey is not certified unless signed and sealed in red ink.
 - 2) This survey is subject to Wisconsin lien laws. This Plat of Survey is the notice of intent to file lien. Lien waiver required.
 - 3) The Survey Date shown on this Plat of Survey is the completion date of the field work.

Copyright ©2018 by Olson Land Surveying, LLC.

All rights reserved. No part of this survey plat may be reproduced or transmitted in any form by any means - graphic, electronic, or mechanical, including photocopying, tracing, or information storage and retrieval systems - without permission in writing from Douglas G. Olson, Olson Land Surveying, LLC.

I hereby certify that I have surveyed the above described property in compliance with Chapter A-E 7 of the Wisconsin Administrative Code and that the map hereon is correct to the best of my professional knowledge and belief and shows the size and location of the property, its exterior boundaries, the location and dimensions of all visible structures thereon, boundary fences, apparent easements and roadways and visible encroachments, if any.
This survey is made for the exclusive use of the present owners of the property, and also those who purchase, mortgage or guarantee title thereto, within one year from the date hereof.

Douglas G. Olson
Wisconsin Professional Land Surveyor - 2093

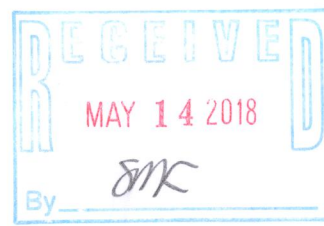

Survey Date: March 28, 2018.
Revisions:

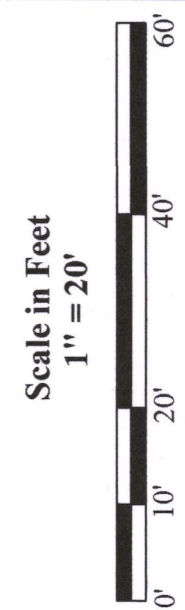

45 South Wisconsin Street | P.O. Box 322
Elkhorn, Wisconsin, 53121
Telephone: (262) 723-3434
Facsimile: (262) 723-8044
Email: doug@olsonsurveying.com
Website: www.olsonsurveying.com



Legend of Symbols & Abbreviations

N	North
S	South
E	East
W	West
°	in Degrees
'	in Minutes
''	in Seconds
ft	in Feet
mi	in Miles
Found County Section Corner	
Found Iron Pin	
Found Iron Rod	
Recorded Information	
Utility Pole	
Utility Pedestal	
Asphalt Surface	
Concrete Surface	
Gravel Surface	
Septic Vent	

Sheet 1 of 1 Sheets
Drawing Name:
Job Reference Number
2018.035
2018.035