

PLAT OF SURVEY AS-BUILT LOCATION

UNIT 38-48
GENEVA NATIONAL CONDOMINIUM
NO. 38
LOCATED IN TOWN 2 NORTH, RANGE 17 EAST
WALWORTH COUNTY, WISCONSIN

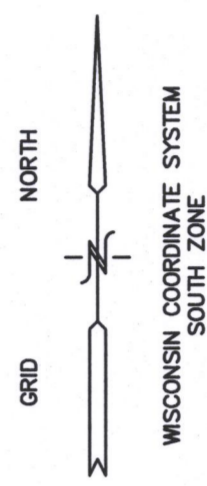

- = FOUND IRON REBAR STAKE
- = FOUND IRON PIPE STAKE
- (xxx) = RECORDED AS
- = SET LATH ON LINE

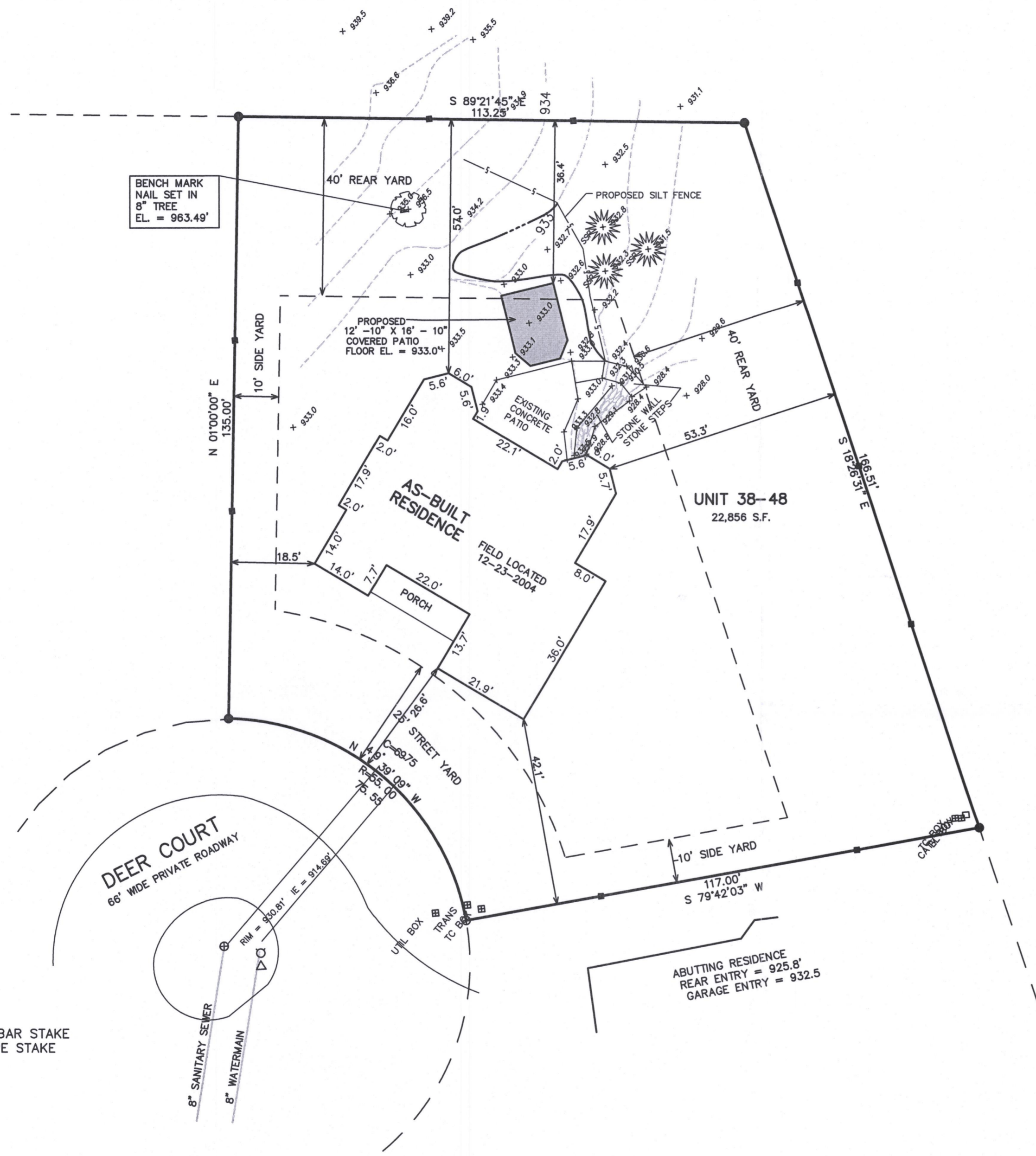
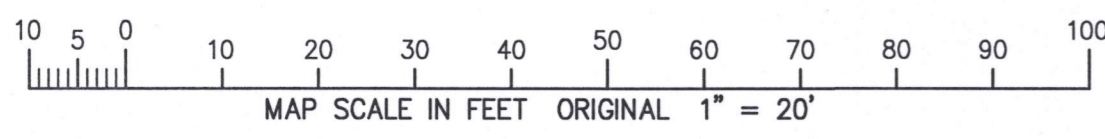

NOTE: COPIES OF THIS MAP TO WHICH THE FOLLOWING CERTIFICATE WILL APPLY SHOW SURVEYOR'S ORIGINAL SEAL AND SIGNATURE IN RED INK. COPIES BY ANY OTHER MEANS MAY HAVE ALTERATIONS WHICH DO NOT REPRESENT THE SURVEYOR'S WORK PRODUCT.

I HEREBY CERTIFY THAT THE ABOVE DESCRIBED PROPERTY HAS BEEN SURVEYED UNDER MY DIRECTION AND THAT THE ABOVE MAP IS A TRUE REPRESENTATION THEREOF AND SHOWS THE SIZE AND LOCATION OF THE PROPERTY AND ITS EXTERIOR BOUNDARIES. THIS SURVEY IS MADE FOR THE USE OF THE PRESENT OWNERS OF THE PROPERTY, AND ALSO THOSE WHO PURCHASE, MORTGAGE, OR GUARANTEE THE TITLE THERETO WITHIN ONE YEAR FROM THE DATE HEREOF.

DATED: SEPTEMBER 9, 2004

Peter S. Gordon
PETER S. GORDON R.L.S. 2101



REVISED 12-27-2004
TO SHOW SIZE & LOCATION OF
AS BUILT FOUNDATION

REVISED 03-27-2017
TO SHOW PROPOSED COVERED
PATIO

REVISED 04-05-2016
TO SHOW SET LATH ON LINE

REVISIONS
09/07/2004
SITE, GRADING,
DRAINAGE, &
EROSION
CONTROL PLAN
09/22/2004
MISC. REVS.

WORK ORDERED BY
HARVEST HOMES
5024 GREENBAY ROAD, SUITE 100
KENOSHA, WI. 53144

FARRIS, HANSEN & ASSOCIATES, INC.
Engineering, Architecture, Surveying
7 Ridgway Court P.O. Box 437
ELKHORN, WISCONSIN 53121
Office: (262) 723-2098
Fax: (262) 723-5886

PROJECT NO.
3269.38-48

DATE:
08-24-04

SHEET NO.
1 OF 1

JCN 38-48

317-4304