



NELSON RESIDENCE

WORK ORDERED BY -  
J. TIMOTHY BUILDERS  
W4732 PEBBLE DRIVE  
ELKHORN, WI 53121

FARRIS, HANSEN & ASSOCIATES, INC.  
Engineering, Architecture, Surveying  
7 Ridgway Court P.O. Box 437  
ELKHORN, WISCONSIN 53121  
Office: (262) 723-2098  
Fax: (262) 723-5886

REVISIONS

PROJECT NO.  
3269-10-02.14

DATE:  
7/31/2014

SHEET NO.  
1 OF 1

PLAT OF SURVEY  
UNIT 10-02  
GENEVA NATIONAL CONDOMINIUM NO. 10  
LOCATED IN TOWN 2 NORTH, RANGE 17 EAST  
WALWORTH COUNTY, WISCONSIN

GENEVA NATIONAL CONDOMINIUM NO. 31  
"GOLF CLUB GROUNDS"

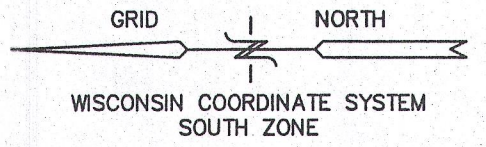

SAND

TRAP

UNIT 10-01

UNIT 10-02  
45,501 S.F. (1.04 AC.)

UNIT 10-03

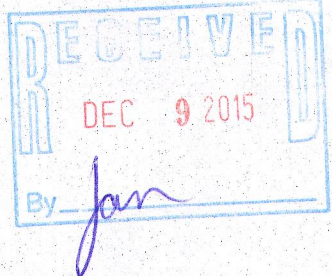

BENCH MARK  
NE FLG BOLT  
ON HYDRANT  
ELEV.=1087.36'

CABLE & TELE.  
BOXES  
TRANSFORMER

R=458.00'  
A=58.26°  
C=68.22°  
N 34° 45' 11" E

RECORD POSITION OF  
LATERALS AS PROPOSED

AS-BUILT FOUNDATION  
(FIELD LOCATED 8/24/2015)

LEGEND

● = FOUND IRON REBAR STAKE

NOTE: COPIES OF THIS MAP TO WHICH THE FOLLOWING CERTIFICATE  
WILL APPLY SHOW THE SURVEYOR'S ORIGINAL SEAL AND SIGNATURE  
IN RED INK. COPIES BY ANY OTHER MEANS MAY HAVE ALTERATIONS  
WHICH DO NOT REPRESENT THE SURVEYOR'S WORK PRODUCT.

I HEREBY CERTIFY THAT THE ABOVE DESCRIBED PROPERTY HAS BEEN  
SURVEYED UNDER MY DIRECTION AND THAT THE ABOVE MAP IS A TRUE  
REPRESENTATION THEREOF AND SHOWS THE SIZE AND LOCATION OF  
THE PROPERTY AND ITS EXTERIOR BOUNDARIES. THIS SURVEY IS  
MADE FOR THE USE OF THE PRESENT OWNERS OF THE PROPERTY, AND  
ALSO THOSE WHO PURCHASE, MORTGAGE, OR GUARANTEE THE TITLE  
THERE TO WITHIN ONE YEAR FROM THE DATE HEREOF.

DATED: AUGUST 9, 2006

REVISED 08-19-2013  
UPDATE TOPO

REVISED 7/31/2014-KB  
SITE, GRADING, DRAINAGE &  
EROSION CONTROL PLAN

REVISED 8/25/2015-KB  
TO SHOW SIZE & LOCATION OF  
AS-BUILT FOUNDATION

PETER S. GORDON R.L.S. 2101

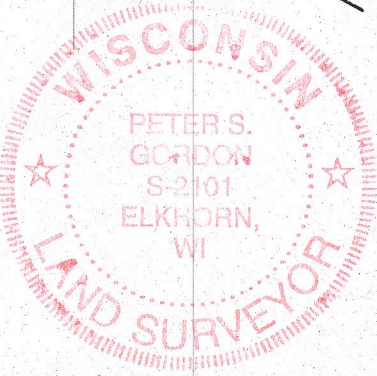

WOODS WAY  
50' WIDE PRIVATE R.O.W.

EXTG. SAN. MH  
RIM=1084.7  
IE={1071.43 NE}  
IE={1071.46 S}

EXTG. SAN. MH  
RIM=1081.3  
IE={1072.14 N}  
IE={1072.17 S}

HYDRANT  
LOCATED

MAP SCALE IN FEET ORIGINAL 1" = 20'

217-4134

JGN 10-2

AUG 26 2015