

Site Plan

of

Lot 1 of Certified Survey Map No. 4328,

recorded in Vol. 28 of Certified Survey Maps of Walworth County on Page 44 and located in the Southeast 1/4 of Section 34, Town 2 North, Range 17 East, Town of Geneva, Walworth County, Wisconsin.



Location Sketch

Southeast 1/4, Section 34-2-17
 Southwest 1/4, Section 35-2-17
 Northwest 1/4, Section 2-1-17
 Northeast 1/4, Section 9-1-17
 1"=1500'

Surveyed for: **Dreamfield, LLC**
 401 North Michigan Avenue - #3200
 Chicago, Illinois. 60611

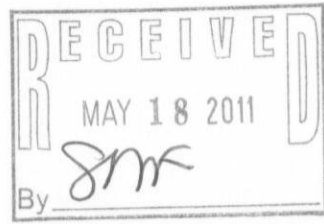

Bearings reference to the Wisconsin State Plane Coordinate System, South Zone.

Tax Parcel
 JG 3400012

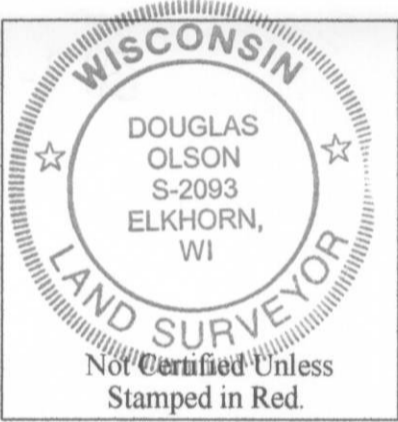

- Notes: 1) This survey plat is not certified unless signed and sealed in red ink.
 2) This survey is subject to Wisconsin lien laws. This Plat of Survey is the notice of intent to file lien. Lien waiver required.

Copyright 2005 by Jensen & Olson Land Surveying, LLC.

All rights reserved. No part of this survey plat may be reproduced or transmitted in any form by any means - graphic, electronic, or mechanical, including photocopying, tracing, or information storage and retrieval systems - without permission in writing from Douglas G. Olson, Jensen & Olson Land Surveying, LLC.

I, Douglas G. Olson, Wisconsin Registered Land Surveyor, do hereby certify that this survey was performed by me or under my direction in full compliance with the owners'/agent's instructions and Chapter A-E 7 of the Wisconsin Administrative Code "Minimum Standards for Property Surveys", and that this map is an accurate representation thereof to the best of my knowledge and belief.

Douglas G. Olson
 Wisconsin Registered Land Surveyor - 2093

Lot 1

Tax Parcel JA432800001

55.354 Acres
 2,411,237 Sq. Ft.
 A-2: 49.16 Acres
 C-2: 7.20 Acres
 54,576 Acres
 2,377,359 Sq. Ft.
 Exclusive of R.O.W.

Tax Parcel
 JG 3400013A

Tax Parcel
 IL 300005

Tax Parcel
 IL 300003

Note: Contours shown in this area are "prior to construction" and are no longer accurate due to on site grading.

Sheet 1 of 1 Sheets
 Drawing Name: I2m17e-2010006-2010006DreamfieldRev8.sxd
 Job Reference Number
 2010.006 F

Legend	
Found County Section Corner	Found Concrete Monument
Found Iron Pipe	Found Iron Rod
Recorded Information	Utility Pole
Utility Pole	Utility Pedestal
Manhole	Catch Basin
Hydrant	Sprinkler System
Concrete Surface	Asphalt Surface
Gravel Surface	

Jensen & Olson Land Surveying, LLC
 45 South Wisconsin Street * P.O. Box 322 * Elkhorn, Wisconsin, 53121
 Telephone: (262) 723-3434 * Facsimile: (262) 723-8044
 Email: jensen.olson@elknet.net

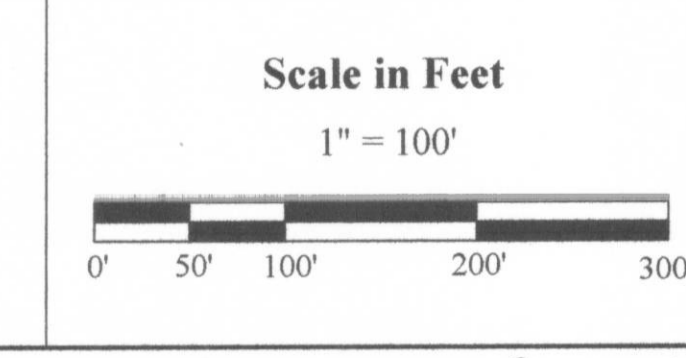

Survey date: December 10, 2002.
 Revisions:
 No. 1 - New Fencing
 No. 2 - Buildings Removed
 No. 3 - Arena Removed
 No. 4 - Pond Enticement
 No. 5 - Utility & Appox. Tree Lines
 No. 6 - Revised Topo @ SW
 No. 7 - Proposed Bldg.
 No. 8 - New Bldg. location
 No. 9 - As-Built Structure

2010.006 F

217-3713