

PREPARED FOR
KEN GUTHRIE
N2406 SHOREVIEW DRIVE
LAKE GENEVA, WI 53147

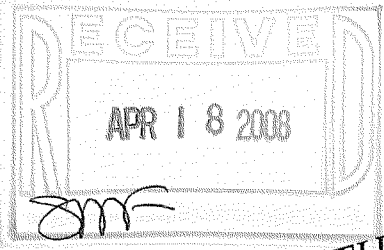

KROTT SURVEYING INC.

N3705 WILLOW BEND LANE
LAKE GENEVA WI. 53147
PHONE # (262)248-3697
FAX # (262)249-0639

PLAT OF SURVEY

- OF -

LOT 1 CERTIFIED SURVEY MAP NO. 1402 LOCATED IN THE
NORTHEAST 1/4 AND THE NORTHWEST 1/4 OF SECTION 13,
T.2.N. R.17.E., WALWORTH COUNTY, WISCONSIN.
EXCEPTING THEREFROM PART OF LOT 1 OF SAID CERTIFIED
SURVEY MAP NO. 1402, DESCRIBED AS FOLLOWS: BEGINNING
AT THE SOUTHWEST CORNER OF LOT 1; THENCE N00°53'50" W
50.00 FEET; THENCE N 80°16'40" E 303.66 FEET; THENCE
S 00°52'30" E 94.90 FEET; THENCE S 88°46'50" W 300.03 FEET
TO THE POINT OF BEGINNING.

FOUND IRON PIPE
ONLINE & 2.00 FEET
SOUTH OF CORNER
TREE AT CORNER



AREA = 5.00 ACRES

COMPARE LEGAL DESCRIPTION ABOVE AND DRAWING WITH DEED.
FOR BUILDING RESTRICTIONS AND EASEMENTS NOT SHOWN, REFER
TO DEED, ABSTRACT SOURCES AND LOCAL MUNICIPAL CODES.
NOTIFY THE SURVEYOR IMMEDIATELY OF ANY DISCREPANCY.

"I hereby certify that I have surveyed the above
described property and that
the above map, to the best of my knowledge and
belief, is a true representation
thereof and shows the size and location of all visible
structures, apparent
easements and encroachments if any." This survey is
made for the present
owners of the property, and those who purchase,
mortgage, or guarantee the
title thereto, within one year from the date hereof.

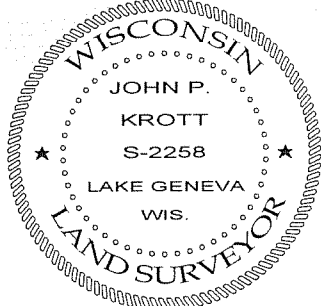

JOHN KROTT S - 2258
Wisconsin Registered Land Surveyor
(original if signed in red)

DATED THIS 13th DAY OF MARCH 2008.

LEGEND

() = recorded as
○ = found iron pipe

SCALE: 1" = 60'

JOB #: 07-2834B

TAX ID #: JA140200001

217-3484