

LAND-MARK SURVEYING
Mark L. Miritz

Wisconsin Registered Land Surveyor S-2582

N9330 Knuteson Drive
Whitewater, WI 53190
Phone: (262) 495-3284
FAX : (262) 495-8421
LAND-MARKSURVEYING.COM

ORDERED BY:
SCHAUDER BUILDING, INC.
4115 U.S. HIGHWAY 51 NORTH
JANESVILLE, WI 53545-9674

OWNERS: DAVID A. & NANCY A. ASCOLANI

PLAT OF SURVEY

**LOTS 3,4,5 AND 6, BLOCK 15, SUNSET HILLS SUBDIVISION,
LOCATED IN SECTION 33, TOWN 2 NORTH, RANGE 17 EAST,
WALWORTH COUNTY, WISCONSIN.**

LAKEVIEW DRIVE
(40' WIDE)

CULVERT

NORTH 159.94'
(160')

LOT 7

N 89°48'02" E 115.24'
(115')

LOT 6

BLOCK 15

1.3 EAST OF LINE

EXISTING RESIDENCE
LOT 5

TAX KEY JSH-32
18,388 SQ. FT. TOTAL

LOT 4

LOT 3

S 89°44'23" W 114.78'
(115')

LOT 2

S 00°09'57" W 159.82'
(160')

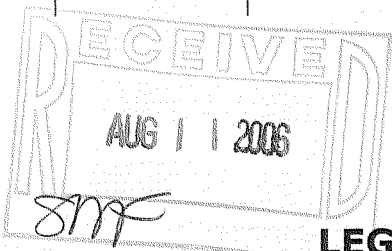

LEGEND

- ⊗ FOUND IRON PIPE
- FOUND IRON ROD
- ⊠ FOUND COUNTY MONUMENT
- ▲ WOOD STAKE SET AT 10' OFFSET
- + CHISEL CUT IN CONCRETE
- SET IRON ROD, 24" LONG, WEIGHING 1.5 LBS./LINEAL FT., 3/4" DIA.
- (x x) RECORDED AS DIMENSION
- x — x — EXISTING FENCE

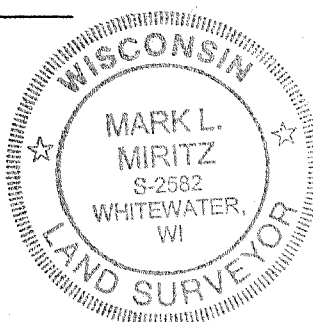
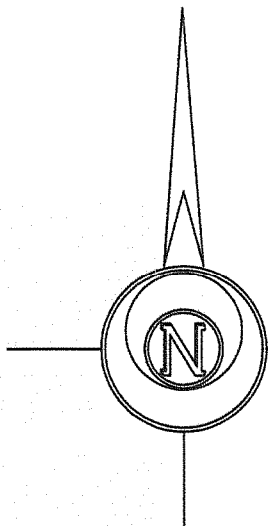

REVISED APRIL 20, 2006
AS BUILT FOUNDATION LOCATED

SCALE: 1" = 20 FEET

"I hereby certify that the above described property has been surveyed by me or under my direction and that the above map is a true representation thereof and shows the size and location of the property, its exterior boundaries, the location of all visible structures and dimensions of all principal buildings thereon, boundary fences, apparent easements, roadways and visible encroachments, if any."
"This survey is made for the use of the present owners of the property, and also those who purchase, mortgage, or guarantee the title thereto within one year from date hereof."

Mark L. Miritz
MARK L. MIRITZ
WISCONSIN REGISTERED
LAND SURVEYOR S-2582

DATE: JANUARY 23, 2006 JOB NO. 06.106

JSH-32

217-3293