

# FARRIS, HANSEN & ASSOCIATES, INC.

ENGINEERING — ARCHITECTURE — SURVEYING  
7 RIDGWAY COURT — P.O. BOX 437 — ELKHORN, WISCONSIN 53121  
PHONE: (262) 723-2098 FAX: (262) 723-5886

## PERMIT PLAT

PARCEL 18 OF ROYAL GLEN WOODLANDS, UNRECORDED  
LOCATED IN PART OF THE SE 1/4 OF SECTION 22, TOWN 2 NORTH,  
RANGE 17 EAST, TOWN OF GENEVA, WALWORTH COUNTY, WISCONSIN

— WORK ORDERED BY —  
TOM DOWNER  
W3474 ROYAL GLEN COURT  
LAKE GENEVA, WI 53147

ASSIGNED EAST LINE OF PARCEL 18  
N 02°36'29" W

ROYAL GLEN COURT (S 89°09'54" E) 66' WIDE R.O.W.  
(S 89°07'34" E)

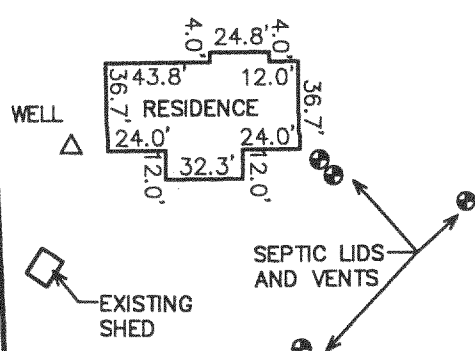

PARCEL 18  
230,129 S.F.  
5.28 AC.

PARCEL 17

SOUTH BANK OF CREEK

PROPOSED BUILDING  
(30'x40')

WOODLAND DRIVE

EXISTING CULVERT

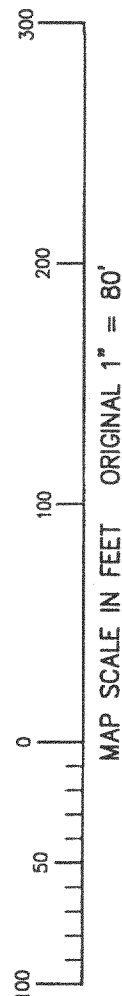

NOTE: COPIES OF THIS MAP TO WHICH THE FOLLOWING CERTIFICATE  
WILL APPLY SHOW THE SURVEYOR'S ORIGINAL SEAL AND SIGNATURE  
IN RED INK. COPIES BY ANY OTHER MEANS MAY HAVE ALTERATIONS  
WHICH DO NOT REPRESENT THE SURVEYOR'S WORK PRODUCT.

I HEREBY CERTIFY THAT THE ABOVE DESCRIBED PROPERTY HAS BEEN  
SURVEYED UNDER MY DIRECTION AND THAT THE ABOVE MAP IS A TRUE  
REPRESENTATION THEREOF AND SHOWS THE SIZE AND LOCATION OF  
THE PROPERTY AND ITS EXTERIOR BOUNDARIES. THIS SURVEY IS  
MADE FOR THE USE OF THE PRESENT OWNERS OF THE PROPERTY, AND  
ALSO THOSE WHO PURCHASE, MORTGAGE, OR GUARANTEE THE TITLE  
THERETO WITHIN ONE YEAR FROM THE DATE HEREOF.

DATED: SEPTEMBER 28, 2005

PETER S. GORDON R.L.S. 2101



LEGEND  
O = FOUND IRON PIPE STAKE  
(XXX) = RECORDED AS

PROJECT: 6887  
DATE: 09/28/05  
SHEET 1 OF 1

JRG 00018

217-3130