

PREPARED FOR:
DIANE COCROFT
KEEFE REALTY
751 GENEVA PARKWAY
LAKE GENEVA WI 53147

PLAT OF SURVEY

J.K. SURVEYING INC.
N3705 WILLOWBEND LANE
LAKE GENEVA, WI, 53147
262-248-3697

- OF -

LOTS 4576-4585 BLOCK 79 OF LAKE COMO BEACH SUBDIVISION;
LOCATED IN TOWN 2 NORTH, RANGE 17 EAST, WALWORTH COUNTY,
WISCONSIN

C.L. DAISY DRIVE

(40' WIDE ROAD)

C.L. WALNUT ROAD

(40' WIDE ROAD)

(S 89°39'56" E 100.00')
S 89°39'41" E 100.42'

LOT 4580

LOT 4576

LOT 4581

(N 00°20'04" E 200.00')
N 00°20'04" E 199.52'

S 00°26'17" W 199.67'
(S 00°20'04" W 200.00')

BLOCK 79

LOT 4585

N 89°34'22" W 100.06'
(N 89°39'56" W 100.00')

FENCE IS 0.36'
EAST OF LINE

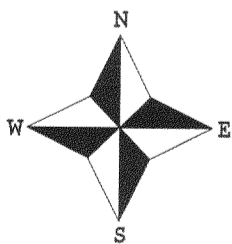

() = recorded as

□ = found iron bar

○ = found iron pipe

● = set iron pipe

■ = set iron bar

SCALE 1" = 20'

JOB # 04-195

TAX ID # JLCB00905

COMPARE LEGAL DESCRIPTION ABOVE AND DRAWING WITH DEED. FOR BUILDING RESTRICTIONS AND EASEMENTS NOT SHOWN, REFER TO DEED, ABSTRACT SOURCES AND LOCAL MUNICIPAL CODES. NOTIFY THE SURVEYOR IMMEDIATELY OF ANY DISCREPANCY.

"I hereby certify that I have surveyed the above described property and that the above map, to the best of my knowledge and belief, is a true representation thereof and shows the size and location of all visible structures, apparent easements and encroachments if any."

This survey is made for the present owners of the property, and those who purchase, mortgage, or guarantee the title thereto, within one year from the date hereof.

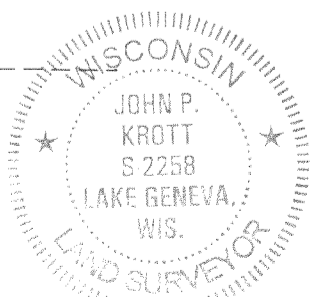
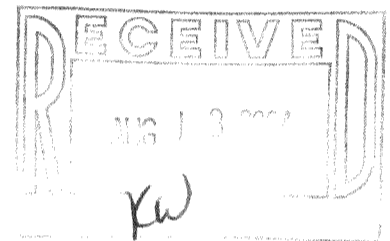

John P. Krott

JOHN KROTT S - 2258
Wisconsin Registered Land Surveyor
(original if signed in red)

DATED THIS THE 27th DAY OF APRIL 2004.

217-2868