

DENNIS PETERSON
5932 SPRING VALLEY RD.
BURLINGTON, WI
53105

- OF -

LOT 15 WILLOW BEND PARK A SUBDIVISION LOCATED IN
T.2N., R.17E., WALWORTH COUNTY, WISCONSIN
EXCEPTING THAT PART OF LOT 15 DESCRIBED AS FOLLOWS:
BEGINNING AT THE SOUTHEAST CORNER OF SAID LOT 15;
THENCE N 79°41'30" E 71.30 FEET; THENCE N 14°34'22" E
184.39 FEET; THENCE S 55°36'20" W 164.80 FEET; THENCE
S 11°12'05" E 100.00 FEET TO THE POINT OF BEGINNING.

ALSO: THAT PART OF LOT 14 WILLOW BEND PARK DESCRIBED AS FOLLOWS: BEGINNING AT THE NORTHEAST CORNER OF LOT 15; THENCE 143.02 FEET ALONG THE ARC OF A CURVE TO THE LEFT WITH A RADIUS OF 1036 FEET AND WHOSE CHORD BEARS S 28°00'47" E A DISTANCE OF 142.91 FEET; THENCE S 55°35'41" W 147.34 FEET; THENCE N 14°34'22" E 216.38 FEET TO THE POINT OF BEGINNING

J.K. SURVEYING INC.
N3705 WILLOWBEND LANE
LAKE GENEVA, WI, 53147
262-248-3697

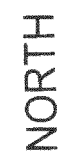

SCALE 1"=30'

JOB # 01-253

TAX ID # JWSB-15

DATE OF LAST REVISION: 12/13/2001

DATE OF LAST REVISION: 8/30/2001

"I hereby certify that I have surveyed the above described property and that the above map is a true representation thereof and shows the size and location of all visible structures, apparent easements and encroachments if any."

This survey is made for the present owners of the property, and those who purchase, mortgage, or guarantee the title thereto, within one year from the date hereof.

COMPARE LEGAL DESCRIPTION ABOVE AND DRAINING WITH DEED. FOR BUILDING RESTRICTIONS AND EASEMENTS NOT SHOWN REFER TO DEED. ABSTRACT SOURCES AND LOCAL MUNICIPAL CODES. NOTIFY THE SURVEYOR IMMEDIATELY OF ANY DISCREPANCY

DATED THIS 28 TH. DAY OF JUNE 20 01 .

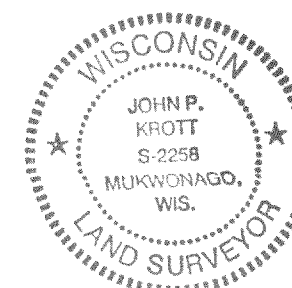
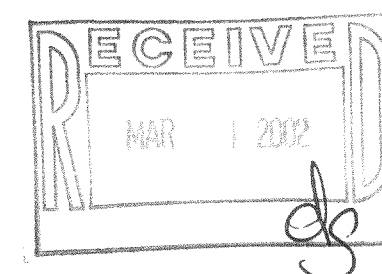

JOHN KROTT S - 2258
Wisconsin Registered Land Surveyor
(original if signed in red)

JW58-15 217-2226