

ABERNATHY and ASSOCIATES

Kenneth B. Abernathy Jr.

Wisconsin Registered Land Surveyor S-1594

Rt. 3, Box 273  
Elkhorn, Wisconsin 53121  
Phone: (414) 723-4260 (office)  
(414) 723-7209 (FAX)

PLAT OF SURVEY

Lot 4 of Certified Survey Map Number 2911 as recorded in Vol. 15 of Certified Survey Maps as pages 149-155 as Document Number 366205, being a resubdivision of Lot 4 of Certified Survey Map Number 2072, located in the Southeast 1/4 of Section 23, Town 2 North, Range 17 East, Town of Geneva, Walworth County, Wisconsin.

66' WIDE  
KRUEGER  
ROAD

U.S.H.  
"12"

66' WIDE  
ACCESS EASEMENT

VOL. 649 P. 8207  
DOC. NO. 364596

LOT 2

LOT 1

20' WIDE SEPTIC EASEMENT FOR LOT 1

N 89°11'39"E 370.61'  
304.61'

N 89°11'39"E 453.21'

N 89°11'39"E 365.19'

20' WIDE SEPTIC EASEMENT FOR LOT 3

EASEMENT AREA = 3496 S.F.

40.58'

LOT 3

C.S.M. # 2072

CURVE	ARC	DELTA	RADIUS	CHORD LENGTH	CHORD BEARING
C1	105.92	91°56'48"	66.00	94.91	S 45°10'12" W

UPLAND AREA NET = 144,603 S.F.

LOT 4

202,183 SQ. FT.

SHORELAND ZONING LINE

LOT 3

N 1°08'43" E 642.56'

S 8°49'06" W 595.01'

100 YEAR FLOOD ELEVATION = 850

LOWLAND AREA = 54,084 S.F.

N 77°29'06" E  
304.76'

COMO CREEK

OWNERS: JEFF AND DANA ANDERSON  
W4727 PEBBLE DRIVE  
ELKHORN, WI. 53121

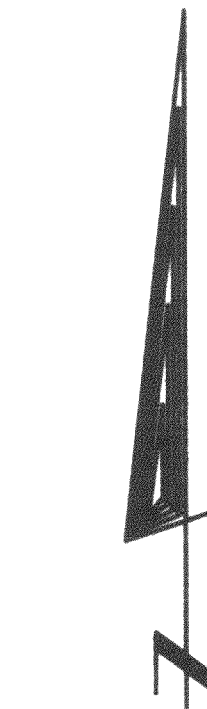

SCALE 1" = 80 FEET

Legend

- FOUND IRON PIPE
- FOUND IRON ROD
- FOUND BRASS CAPPED MONUMENT
- ✱ FOUND CONCRETE MONUMENT
- + CHISEL CUT IN CONCRETE
- SET IRON ROD, 24" LONG, WEIGHING 1.5 LBS., LINEAL FT., 3/4" DIA.
- SET IRON ROD, 30" LONG, WEIGHING 4.5 LBS., LINEAL FT., 1-11/16" DIA.
- (XX) RECORDED AS DIMENSION
- - - EXISTING FENCE

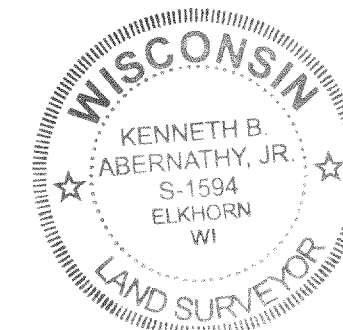
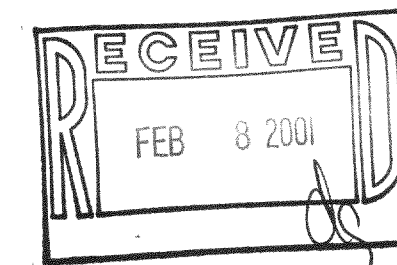

SCALE: 1" = 80 FEET

"I hereby certify that the above described property has been surveyed by me or under my direction and that the above map is a true representation thereof and shows the size and location of the property, its exterior boundaries, the location of all visible structures and dimensions of all principal buildings thereon, boundary fences, adjacent easements, roadways and visible encroachments, if any."  
"This survey is made for the use of the present owners of the property and also those who purchase, mortgage, or guarantee the title thereto within one year from date hereof."

*Kenneth B. Abernathy, Jr.*

KENNETH B. ABERNATHY, JR.  
WISCONSIN REGISTERED LAND SURVEYOR,  
S-1594

Date: DEC. 15, 2000 Job No. 00.1201

JA-2911-4

217-2027

DESIGN PRODUCTS 027-01