

# ABERNATHY and ASSOCIATES

Kenneth B. Abernathy Jr.

Wisconsin Registered Land Surveyor S-1594

W4056 BRAY RD.  
ELKHORN, WI. 53121  
PHONE: (262) 723-4260 (OFFICE)  
(262) 723-7209 (FAX)  
Email: abernathy@elknet.net

## PLAT OF SURVEY

### LEGAL DESCRIPTION

Part of the West 1/2 the of Northeast 1/4 of Section 3, Town 2 North, Range 17 East, Walworth County, Wisconsin, described as follows: Commence at the North 1/4 Corner of said Section 3; thence S 0°53'47" E along the north and south 1/4 section line 350.00 feet to a found iron rod and the point of beginning; thence N 89°39'08" E 175.00 feet to a found iron rod; thence N 0°53'47" W 350.00 feet to a point in the north line of said section; thence N 89°39'08" E along the north line of said section and the centerline of Loveland Road 360.00 feet; thence S 0°53'47" E 550.00 feet; thence S 89°39'08" W 535.00 feet; thence N 0°53'47" W along the north - south 1/4 section line 200.00 feet to the point of beginning. Said parcel contains 5.35 acres and is subject to the rights of the public for Loveland Road.

OWNERS: FLORENCE WIESBROOK AND LOIS KONICEK  
11843 GALINA ROAD  
PLANO, IL. 60545

TOWN OF LAFAYETTE

LOVELAND ROAD

ROAD 66' WIDE

NORTH 1/4 CORNER  
SEC. 3-2-17

NORTHEAST CORNER  
SEC. 3-2-17

TOWN OF GENEVA

JG 3 0000 2A  
1.41 AC.

WOODED LANDS  
NEVER USED FOR AGRICULTURAL PRODUCTION

### PROPOSED REZONE

A-1 TO C-2  
232,989 S.F. GROSS  
(5.35 ACRES)  
221,110 S.F.  
(5.08 ACRES)  
EXCLUSIVE OF ROAD

SOILS  
TEST  
AREA

SOIL BORING (TYPICAL)

UNPLATTED LANDS OWNED BY PLATTER ZONED A-1

EDGE OF WORKLAND

UNPLATTED LANDS OWNED BY PLATTER ZONED A-1  
SEE PLAT OF SURVEY DATED AUG. 30, 1999  
ENTIRE FARM

SOUTH 1/4 CORNER  
SEC. 3-2-17

### Legend

- FOUND IRON PIPE
- FOUND IRON ROD
- FOUND BRASS CAPPED MONUMENT
- ⊕ FOUND CONCRETE MONUMENT
- + CHISEL CUT IN CONCRETE
- SET IRON ROD, 24" LONG, WEIGHING 1.5 LBS./LINEAL FT., 3/4" DIA.
- SET IRON ROD, 30" LONG, WEIGHING 4.5 LBS./LINEAL FT., 1-11/16" DIA.
- (xx) RECORDED AS DIMENSION
- x-x- EXISTING FENCE

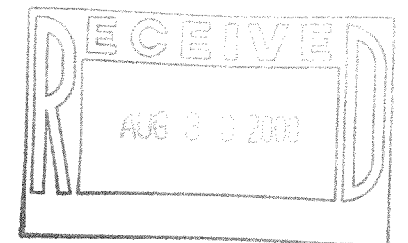
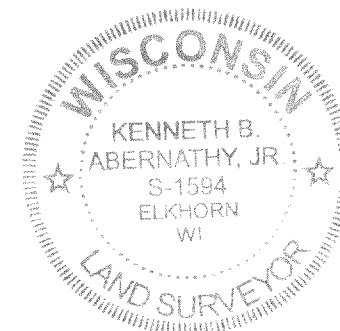

SCALE: 1"=100 FEET

"I hereby certify that the above described property has been surveyed by me or under my direction and that the above map is a true representation thereof and shows the size and location of the property, its exterior boundaries, the location of all visible structures and dimensions of all principal buildings thereon, boundary fences, apparent easements, roadways and visible encroachments, if any."  
"This survey is made for the use of the present owners of the property, and also those who purchase, mortgage, or guarantee the title thereto within one year from date hereof."

Kenneth B. Abernathy, Jr.  
WISCONSIN REGISTERED LAND SURVEYOR,  
S-1594

Date: 7/14/2000 Job No. 99.702

217-1978

JA 3312-1  
(part of) JG-3-2