

ABERNATHY and ASSOCIATES

Kenneth B. Abernathy Jr.

Wisconsin Registered Land Surveyor S-1594

W4056 Bray Road
Elkhorn, Wisconsin 53121
Phone: (414) 723-4260 (office)
(414) 723-7209 (fax)

PLAT OF SURVEY

LOT 22 OF LAKE FOREST ESTATES, A SUBDIVISION LOCATED IN THE NORTHWEST, SOUTHWEST, AND SOUTHEAST 1/4's OF THE SOUTHWEST 1/4 OF SECTION 26, THE SOUTHEAST AND THE NORTHEAST 1/4's OF THE SOUTHEAST 1/4 OF SECTION 27, AND THE NORTHEAST 1/4 OF THE NORTHWEST 1/4 OF SECTION 35, ALL IN TOWN 2 NORTH, RANGE 17 EAST, TOWN OF GENEVA, WALWORTH COUNTY, WISCONSIN.

LOT 21

N 88°28'13" E 381.02'

10' WIDE UTILITY EASEMENT

DRAINAGE EASEMENT

UNPLATTED LANDS

LOT 22
100,421 SQ. FT.
2.305 AC.

PROPOSED RESIDENCE
(PRELIMINARY STAKEOUT BY BUILDER)

UNPLATTED LANDS

RADIUS = 863.00'
I = 17°39'40"

ORDERED BY: WYNTREE CONSTRUCTION
P.O. BOX 460
LAKE GENEVA, WI. 53147

OWNER: MCNAMARA

LOT 23

SCALE 1" = 20 FEET

Horizontal Datum is based on the Wisconsin State Plane Coordinate System Grid, South Zone, and all bearings are referred to Grid North.

Legend

- FOUND IRON PIPE
- FOUND IRON ROD
- FOUND BRASS CAPPED MONUMENT
- FOUND CONCRETE MONUMENT
- CHISEL CUT IN CONCRETE
- SET IRON ROD, 24" LONG, WEIGHING 1.5 LBS./LINEAL FT., 1-1/4" DIA.
- SET IRON ROD, 30" LONG, WEIGHING 4.5 LBS./LINEAL FT., 1-1/16" DIA.
- RECORDED AS DIMENSION
- EXISTING FENCE

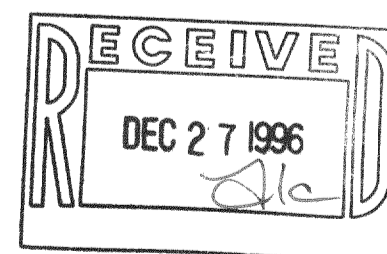

SCALE: 1" = 20 FEET

I hereby certify that the above described property has been surveyed by me or under my direction and that the above map is a true representation thereof and shows the size and location of the property, its exterior boundaries, the location of all visible structures and dimensions of all principal buildings thereon, boundary lines, apparent easements, roadways and visible encroachments, if any. This survey is made for the use of the present owners of the property, and also those who purchase, mortgage, or guarantee the title thereto, within one year from date hereof.

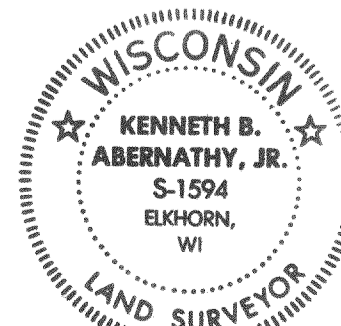

Kenneth B. Abernathy, Jr.
WISCONSIN REGISTERED LAND SURVEYOR, S-1594

Date: 12-23-96 Job No. 96-1213

JLFE-22
217-1438