

Plat of Survey

of Lot 2 of Certified Survey Map No. 4700,

recorded in Vol. 31 of Certified Survey Maps of Walworth County on Page 82 and located in the Southeast 1/4 of the Northwest 1/4 of Section 25, Town 2 North, Range 17 East, Town of Geneva, Walworth County, Wisconsin.

Surveyed for: **Sally English**
47 Sunny Side Lane
Sunfish Lake, Minnesota. 55118

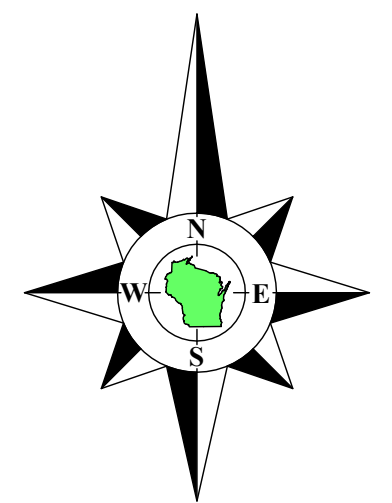

Bearings referenced to the West line of Certified Survey Map No. 4700, recorded as N0°05'00"E, which produces a bearing of N0°02'19"E on the East line of the Northwest 1/4 of Section 25-2-17. A rotation of -0°41'03" from the Wisconsin State Plane Coordinate System, South Zone, (NAD-27).
Coordinates are referenced to the Wisconsin State Plane Coordinate System, South Zone, (NAD-27).

North 1/4 Corner Section 25-2-17
(N. 226,786.95)
(E. 2,421,805.76)

Center 1/4 Corner Section 25-2-17
(N. 224,166.96)
(E. 2,421,836.82)
(Elevation=868.93)

Survey Date: April 21, 2023.
Revisions:

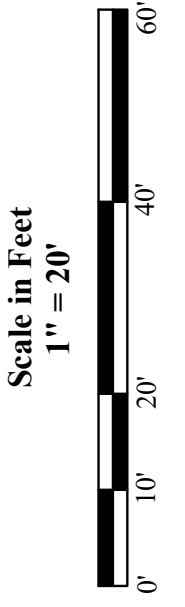

45 South Wisconsin Street | P.O. Box 322
Elkhorn, Wisconsin. 53121
Telephone: (262) 723-3434
Facsimile: (262) 723-8044
Email: doug@olsonsurveying.com
Website: www.olsonsurveying.com

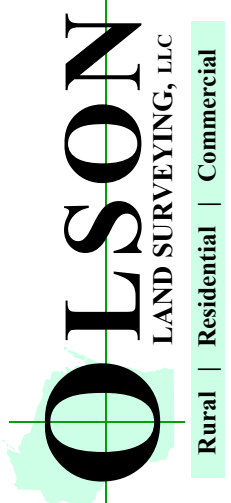

Legend of Symbols & Abbreviations

Found County Section Corner	North	North
Found Iron Pipe	East	East
Found Wood Pipe	West	West
Recorded Information	Minutes	Minutes
Utility Pole	Degrees	Degrees
Utility Pedestal	Feet	Feet
Concrete Cover	Inches	Inches
Asphalt Surface	Gravel Surface	Gravel Surface

Sheet 1 of 1 Sheets
Drawing Name
Job Reference Number
2022.135

2022.135

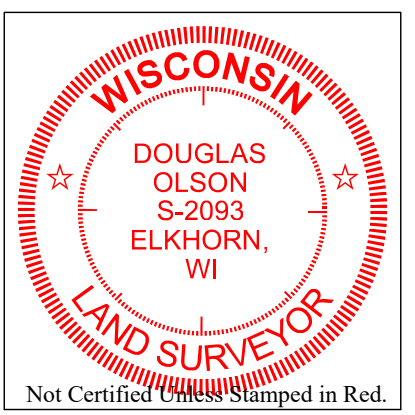

- Notes:**
- This Plat of Survey is not certified unless signed and sealed in red ink.
 - This survey is subject to Wisconsin lien laws. This Plat of Survey is the notice of intent to file lien. Lien waiver required.
 - The Survey Date shown on this Plat of Survey is the completion date of the field work.

Copyright ©2023 by Olson Land Surveying, LLC.

All rights reserved. No part of this survey plat may be reproduced or transmitted in any form by any means - graphic, electronic, or mechanical, including photocopying, tracing, or information storage and retrieval systems - without permission in writing from Douglas G. Olson, Olson Land Surveying, LLC.

I hereby certify that I have surveyed the above described property in compliance with Chapter A-E 7 of the Wisconsin Administrative Code and that the map hereon is correct to the best of my professional knowledge and belief and shows the size and location of the property, its exterior boundaries, the location and dimensions of all visible structures thereon, boundary fences, apparent easements and roadways and visible encroachments, if any.

This survey is made for the exclusive use of the present owners of the property, and also those who purchase, mortgage or guarantee title thereto, within one year from the date hereof.

Douglas G. Olson
Wisconsin Professional Land Surveyor - 2093