

# PLAT OF SURVEY

UNIT 10-02  
GENEVA NATIONAL CONDOMINIUM  
NO. 10

LOCATED IN TOWN 2 NORTH, RANGE 17 EAST  
WALWORTH COUNTY, WISCONSIN

TRAP GENEVA NATIONAL CONDOMINIUM NO. 31  
GOLF CLUB GROUNDS

## LEGEND

- = FOUND IRON REBAR STAKE
- = FOUND IRON REBAR STAKE
- (xxx) = RECORDED AS

Unit 10-2, together with said unit's undivided interest in the common elements all in Geneva National Condominium No. 10, a condominium declared and existing under and by virtue of the Condominium Ownership Act of the State of Wisconsin and recorded by a Declaration as such condominium in the Office of the Register of Deeds for Walworth County, Wisconsin, as Document No. 683920, said condominium being located in the Town of Geneva, County of Walworth, State of Wisconsin on the real estate described in said Declaration and incorporated herein by this reference thereto.

Tax Key No. JGN 1000002

UNIT 10-01

UNIT 10-02  
45,501 S.F. (1.04 AC.)

UNIT 10-03

PROPOSED SANI.  
MANHOLE #1  
IE=1086.75'  
IE=1070.79' N  
IE=1070.84' SW

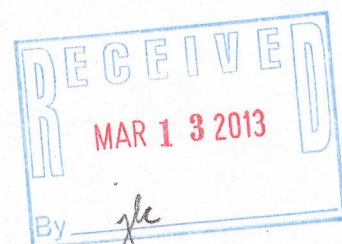

NOTE: COPIES OF THIS MAP TO WHICH THE FOLLOWING CERTIFICATE WILL APPLY SHOW THE SURVEYOR'S ORIGINAL SEAL AND SIGNATURE IN RED INK. COPIES BY ANY OTHER MEANS MAY HAVE ALTERATIONS WHICH DO NOT REPRESENT THE SURVEYOR'S WORK PRODUCT.

I HEREBY CERTIFY THAT THE ABOVE DESCRIBED PROPERTY HAS BEEN SURVEYED UNDER MY DIRECTION AND THAT THE ABOVE MAP IS A TRUE REPRESENTATION THEREOF AND SHOWS THE SIZE AND LOCATION OF THE PROPERTY, ITS EXTERIOR BOUNDARIES, THE LOCATION OF ALL VISIBLE STRUCTURES, AND DIMENSIONS OF ALL PRINCIPLE BUILDINGS THEREON, BOUNDARY FENCES, APPARENT EASEMENTS, ROADWAYS, AND VISIBLE ENCROACHMENTS, IF ANY. THIS SURVEY IS MADE FOR THE USE OF THE PRESENT OWNERS OF THE PROPERTY, AND ALSO THOSE WHO PURCHASE, MORTGAGE, OR GUARANTEE THE TITLE THERETO WITHIN ONE YEAR FROM THE DATE HEREOF.

DATED: MARCH 8, 2013

PETER S. GORDON

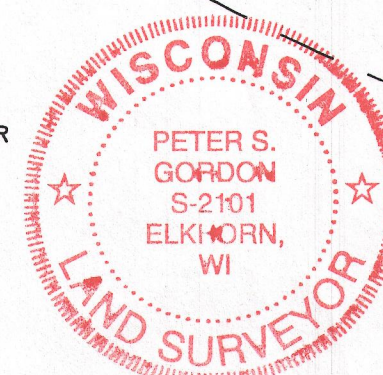

NOTE: THERE EXISTED 1' +/- OF SNOW COVER ON THE DATE OF THIS SURVEY. USERS SHOULD CONFIRM THERE WERE NO ADDITIONAL UTILITIES OR OTHER MATTERS COVERED BY SNOW.

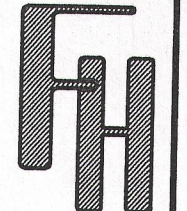
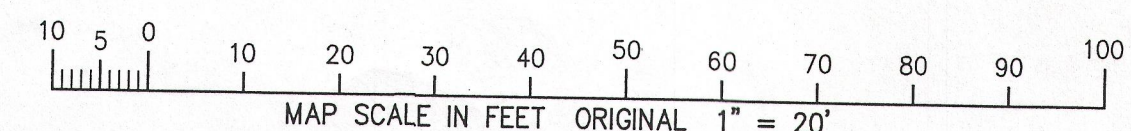

WORK ORDERED BY -  
KEEFE REAL ESTATE  
PO BOX 460  
LAKE GENEVA, WI.

FARRIS, HANSEN & ASSOCIATES, INC.  
Engineering, Architecture, Surveying  
7 Ridgway Court P.O. Box 437  
ELKHORN, WISCONSIN 53121  
Office: (262) 723-2098  
Fax: (262) 723-5886

## REVISIONS

PROJECT NO.  
3269.10.02  
DATE:  
08-09-06  
SHEET NO.  
1 OF 1

JGN 1000002

217-3853