

PLAT OF SURVEY

LEGAL DESCRIPTION:

(VOL. 827 P. 7045)

LOT 1 OF CERTIFIED SURVEY MAP NO. 2392 LOCATED IN THE SOUTHEAST 1/4 OF THE SOUTHEAST 1/4 AND THE SOUTHWEST 1/4 OF THE SOUTHEAST 1/4 OF SECTION 1, TOWN 2 NORTH, RANGE 17 EAST, WALWORTH COUNTY, WISCONSIN, RECORDED IN VOLUME 12 OF CERTIFIED SURVEY MAPS ON PAGE 6 AS DOCUMENT NO. 274131.

TOGETHER WITH THE FOLLOWING DESCRIBED REAL ESTATE WHICH EFFECTUATES A LOT LINE ADJUSTMENT AND ATTACHES THE REAL ESTATE DESCRIBED HEREINBELOW TO LOT 1 OF CERTIFIED SURVEY MAP NO. 2392, TO-WIT:
BEGINNING AT THE NORTHWEST CORNER OF LOT 1 OF CERTIFIED SURVEY MAP NO. 2392 DESCRIBED HEREINABOVE AND THE PLACE OF BEGINNING; THENCE N 89°57'10" E 775.00 FEET; THENCE N 1°25'20" W 47.25 FEET; THENCE S 89°57'10" W 754.76 FEET; THENCE S 21°58'45" W 50.95 FEET TO THE POINT OF BEGINNING.

RESERVING UNTO THE GRANTOR A PERPETUAL EASEMENT FOR UNDERGROUND UTILITIES OVER AND ACROSS THE EASTERLY 1 ROD OF THE ABOVE DESCRIBED REAL ESTATE FOR THE INSTALLATION OF UNDERGROUND UTILITIES, INCLUDING GAS, TELEPHONE AND ELECTRICITY.

OWNERS: JOLINE AND RUSS LINECK
P.O. BOX 77
SPRINGFIELD, WI. 53176

UNPLATTED LANDS OWNED BY OTHERS

(N 89°57'10" E 754.76')

S 89°55'55" W 754.59'

LOT LINE ADJUSTMENT AREA

S 89°57'43" W 774.85'

(REC. AS N 89°57'10" E 775.00')

LAST FLAG LOCATED

3.89 AC. ZONED C-4

11.81 AC. ZONED C-2

NOTE: WETLAND DELINEATION WAS DETERMINED BY THE WISCONSIN DEPARTMENT OF NATURAL RESOURCES.

LINE	BEARING	DISTANCE
L1	N 30°53'40" E	44.30
L2	N 45°38'41" E	27.33
L3	N 31°46'06" E	50.61

LOT 1 C.S.M. # 2392

EASEMENT 16.5' WIDE

SOUTH 1/4 CORNER
SEC. 1-2-17

SOUTH LINE SEC. 1-2-17

S 89°57'10" W 1075.00'

HOSPITAL ROAD

SE CORNER
SEC. 1-2-17

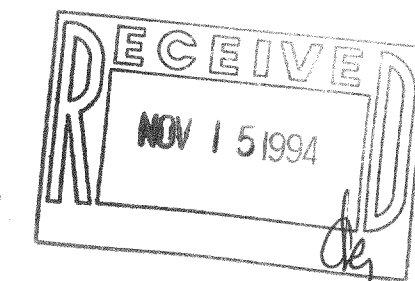

SCALE: 1" = 50 FEET

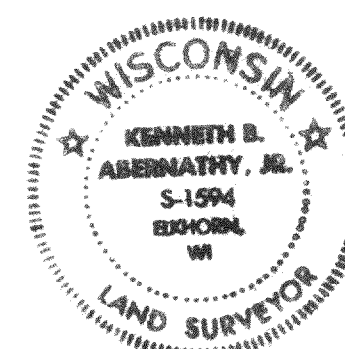

I hereby certify that the above described property has been surveyed by me or under my direction and that the above map is a true representation thereof and shows the size and location of the property, its exterior boundaries, the location of all visible structures and dimensions of all principal buildings thereon, boundary fences, apparent easements, roadways and visible encroachments, if any.
This survey is made for the use of the present owners of the property and also those who purchase, mortgage, or guarantee the title thereto within one year from date hereof.

Kenneth B. Abernathy, Jr.
KENNETH B. ABERNATHY, JR.
WISCONSIN REGISTERED LAND SURVEYOR,
S-1594

Date: 8-2-94 Job No. 94-517

217-1246