

**ABELL
SURVEYING & MAPPING
DELAVAN, WISCONSIN 53115
414-728-6737**

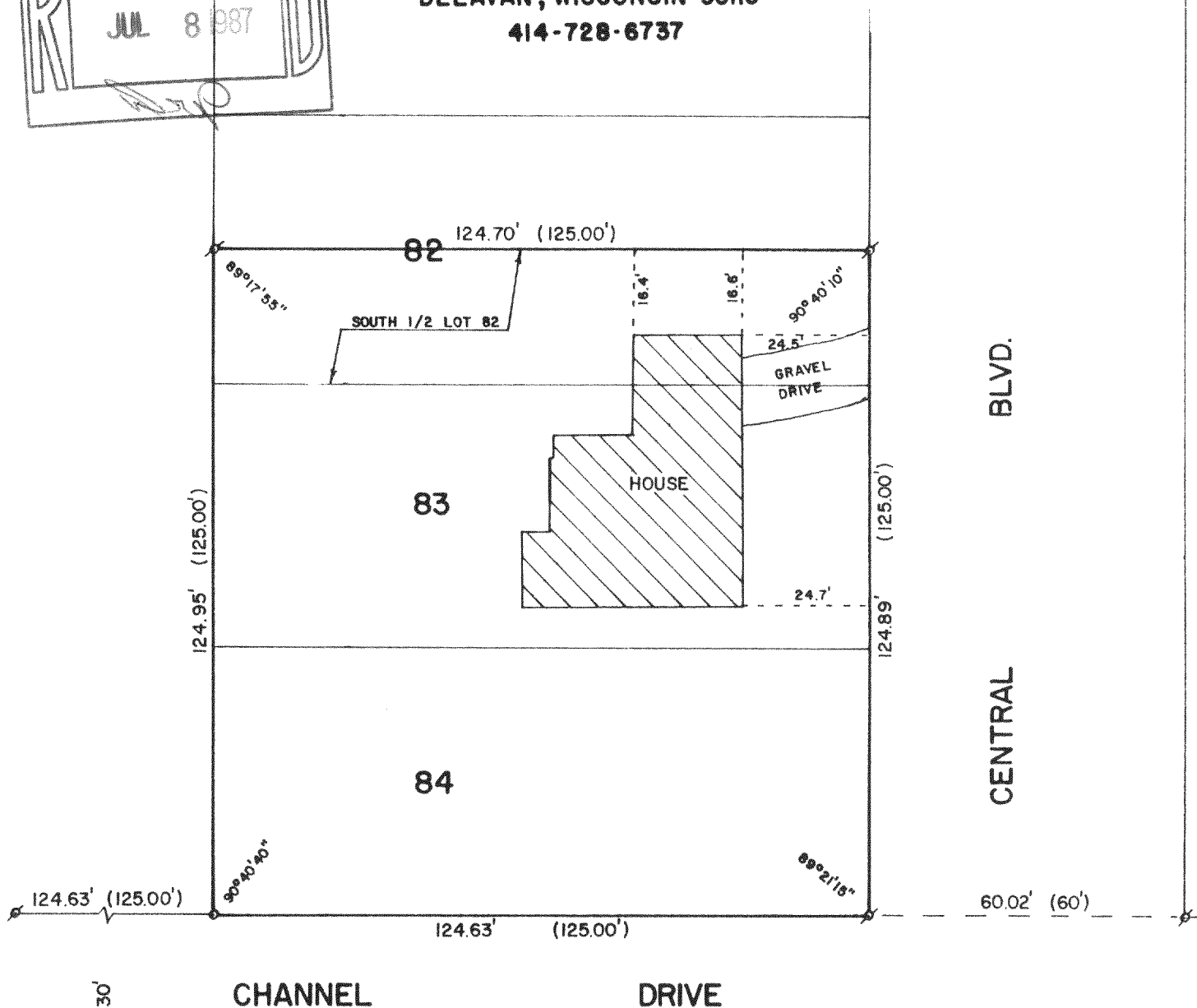

PLAT OF SURVEY OF

LOTS 83 AND 84 AND THE SOUTH 1/2 OF LOT 82, LAKE DELAVAN HIGHLANDS, A SUBDIVISION LOCATED IN SECTION 31, T2N, R16E, WALWORTH COUNTY, WISCONSIN.

ORDERED BY: KEEFE REAL ESTATE
704 W. MAIN ST.
LAKE GENEVA, WI 53147



SCALE - 1"=30'

LEGEND

- ⊕ - IRON PIPE FOUND
- - IRON ROD SET
- () - RECORDED AS

I, DAVID F. ABELL, DO HEREBY CERTIFY THAT I HAVE SURVEYED THE PROPERTY HEREON DESCRIBED ACCORDING TO THE OFFICIAL RECORDS AND THAT THE PLAT HEREON IS A CORRECT REPRESENTATION OF THE PROPERTY LINES TO THE BEST OF MY KNOWLEDGE AND BELIEF.

David F. Abell

DAVID F. ABELL
WISCONSIN REGISTERED LAND SURVEYOR, S-1596

DATE June 22, 1987 JOB NUMBER - 87080

NOTE: THIS IS NOT A CERTIFIED COPY UNLESS SEALED.