

LOCATION: Mound Road, Delavan , Wisconsin
PREPARED FOR: Shodeen Homes
PROPERTY DESCRIPTION: See Below
CURRENT OWNER: Covington Court Apartments LLC
TAX ID: FA334500001, FA334500003, F D 1400003, & F D 1400001A

PROPERTY DESCRIPTION OF LANDS TO BE TRANSFERRED FROM
FA334500003 TOFA334500001:
 (Shown as a Shaded Red Area)
 Part of Lot 3, Certified Survey Map No.: 3345, being a part of the Northwest $\frac{1}{4}$ and the Northeast $\frac{1}{4}$ of the Town of $\frac{1}{4}$ of Section 14, Township 2 North, Range 16 East, located in the Town of Delavan, Walworth County, Wisconsin bound and described as follows:
 Beginning at the Northeast corner of said Lot 3; thence South 25°20'32" West, along the East line of Lot 3, 64.57 feet;thence South 00°59'44" East, along the East line of Lot 3, 46.78 feet; thence South 89°00'16" West, 375.19 feet to the West line of said Lot 3; thence North 00°12'30" West, 104.66 feet, along the West line of Lot 3, to the Northwest corner of Lot 3; thence North 89°00'16" East, 402.40 feet to the Place of Beginning of this description.

Said area contains 40,053 S.F. or 0.9195 Acres of Land more or less.

Lot 3, Certified Survey Map No.: 3345, being a part of the Northwest $\frac{1}{4}$ and the Northeast $\frac{1}{4}$ of the Northeast $\frac{1}{4}$ of Section 14, and part of the Southeast $\frac{1}{4}$ and the Southwest $\frac{1}{4}$ of the Southeast $\frac{1}{4}$ of Section 11, all in Township 2 North, Range 16 East, located in the Town of Delavan, Walworth County, Wisconsin.

Said are contains 267,969 S.F. or 6.1517 Acres of Land more or less.

Lot 1, Certified Survey Map No.: 3345, being a part of the Northwest $\frac{1}{4}$ and the Northeast $\frac{1}{4}$ of the Northeast $\frac{1}{4}$ of Section 14, and part of the Southeast $\frac{1}{4}$ and the Southwest $\frac{1}{4}$ of the Southeast $\frac{1}{4}$ of Section 11, all in Township 2 North, Range 16 East, located in the Town of Delavan, Walworth County, Wisconsin.

Said are contains 284,673 S.F. or 6.5352 Acres of Land more or less.

Legend:

 Found Iron Rod

 Found 1" Iron Pipe

 Found Monument



said area contains 195,187 S.F. or 4.4809 Acres of Land more or less

Lands being a part of the Southwest $\frac{1}{4}$ and Southeast $\frac{1}{4}$ of the Northwest $\frac{1}{4}$, and being a part of the Northwest $\frac{1}{4}$ and Northeast $\frac{1}{4}$ of the Southwest $\frac{1}{4}$, and being a part of the Southwest $\frac{1}{4}$ of the Northeast $\frac{1}{4}$ ALL in section 14, Township 2 North, Range 16 East, located in the Town of Delavan, Walworth County, Wisconsin.

Also Excepting any lands below the Ordinary High Water Mark.

And further Excepting the following described area;

said area contains 4,345,285 S.F. or 99.7540 Acres of Land more or less

Lands being a part of the Southeast $\frac{1}{4}$ of the Northeast $\frac{1}{4}$, Section 14,
Township 2 North, Range 16 East, located in the Town of Delavan, Walworth
County, Wisconsin.

The West 720 Feet of said $\frac{1}{4}$ $\frac{1}{4}$ Section and North of the Ordinary High Water Mark (O.H.W.M.) of Delavan Lake.

And including the following described area;

Lands located in the Southwest $\frac{1}{4}$ of the Northeast $\frac{1}{4}$ of Section 14, Township 2 North, Range 16 East, located in the Town of Delavan, Walworth County, Wisconsin bound and described as follows;

Commencing at the Northeast corner of said Section; thence South $89^{\circ}00'16''$ West on and along the North line of said $\frac{1}{4}$ Section, 1310.60 feet to the North East $\frac{1}{4}$ Corner of said Section; thence South $01^{\circ}38'43''$ East on and along the North-South $\frac{1}{2}$ line, 1319.86 feet to the Northeast $\frac{1}{4}$ Corner of said Section, said point is the Point of beginning of this description; thence continuing South $01^{\circ}38'43''$ East on and along the North-South $\frac{1}{2}$ line, 680.72 feet to the Ordinary High Water Mark (O.H.W.M.) of Delavan Lake; thence Westerly on and along said O.H.W.M. to a point that is South $82^{\circ}13'04''$ West 275.74 feet; thence North $01^{\circ}38'43''$ West and parallel to said North-South $\frac{1}{2}$ line, 714.25 feet to the North line of $\frac{1}{4}$ $\frac{1}{4}$ Section; thence North $89^{\circ}11'49''$ East on and along the East-West $\frac{1}{2}$ line, 274.19 feet to the Place of Beginning of this description.

said area contains 464,980 S.F. or 10.6745 Acres of Land more or less.

Unplatted Lands
Tax Key Number
FD 1400003

Unplatted Lands
Tax Key Number
F D 1400003

FD 1400001A

S82°13'04"W 275.74'

Unplatted Lands
Tax Key Numbers:
F D 1400003

Unplatted Lands
Tax Key Number:
F D 1400001A

Approximate Ordinary High
Water Mark (O.H.W.M.)

East Meand
Corner to t
Center of
Section
14-2-16

DALAVAN LAKE

Unplatted Lands
Tax Key Number:
F D 1400003 -

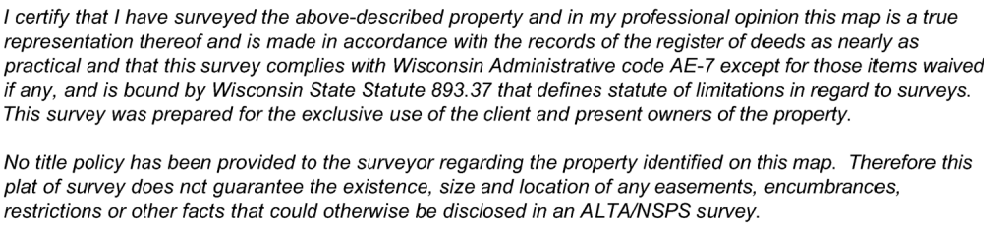

No title policy has been provided to the surveyor regarding the property identified on this map. Therefore the plat of survey does not guarantee the existence, size and location of any easements, encumbrances, restrictions or other facts that could otherwise be disclosed in an ALTA/NSPS survey.

Ritchie P. Wenzel, Professional Land Surveyor, S-402

DRAWING BY: CG
FIELD WORK BY: LG