

Tax Parcel  
FD 300002

recorded as(N89°09'E 321.15')  
**N89°09'40"E 321.01'**

East 1/4 Corner  
Section 3-2-16  
N. 244,643.69  
E. 2,350,261.25

**S0°09'22"W 145.71'**  
recorded as(S0°13'W 145.70')

**Lot 1**  
**Tax Parcel**  
**FROL 00001**

1.561 Acres  
68,018 Sq.Ft.

**Tax Parcel**  
**FD 200006**

# Plat of Survey

of

## Lot 1 in Block 1 of Royal Oaks,

a subdivision located in the Northeast 1/4 of the Southeast 1/4 of Section 3, Town 2 North, Range 16 East, Town of Delavan, Walworth County, Wisconsin.

Surveyed for: **Robert & Christine Deering**  
3116 Royal Oaks Drive  
Elkhorn, Wisconsin. 53121

Copyright ©2022 by Olson Land Surveying, LLC.

All rights reserved. No part of this survey plat may be reproduced or transmitted in any form by any means - graphic, electronic, or mechanical, including photocopying, tracing, or information storage and retrieval systems - without permission in writing from Douglas G. Olson, Olson Land Surveying, LLC.

I hereby certify that I have surveyed the above described property in compliance with Chapter A-E 7 of the Wisconsin Administrative Code and that the map hereon is correct to the best of my professional knowledge and belief and shows the size and location of the property, its exterior boundaries, the location and dimensions of all visible structures thereon, boundary fences, apparent easements and roadways and visible encroachments, if any.

This survey is made for the exclusive use of the present owners of the property, and also those who purchase, mortgage or guarantee title thereto, within one year from the date hereof.

Douglas G. Olson  
Wisconsin Professional Land Surveyor - 2093

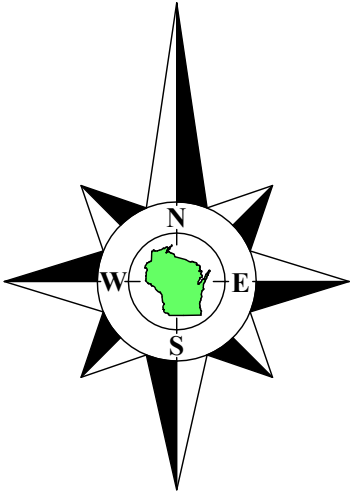

Bearings referenced to the South line of Lot 1 in Block 1, recorded as N60°04'E on the plat of Royal Oaks.  
Coordinates are referenced to the Wisconsin State Plane Coordinate System, South Zone, (NAD-27).

### Notes:

- 1) This Plat of Survey is not certified unless signed and sealed in red ink.
- 2) This survey is subject to Wisconsin lien laws. This Plat of Survey is the notice of intent to file lien. Lien waiver required.
- 3) The Survey Date shown on this Plat of Survey is the completion date of the field work.

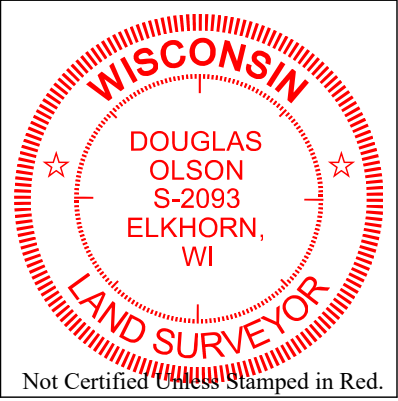

**Survey Date:** November 16, 2022.  
Revisions:

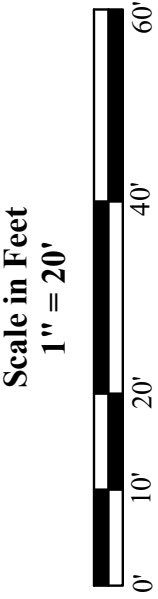

45 South Wisconsin Street | P.O. Box 322  
Elkhorn, Wisconsin. 53121  
Telephone: (262) 723-3434  
Facsimile: (262) 723-8044  
Email: doug@olsonsurveying.com  
Website: www.olsonsurveying.com



Legend of Symbols & Abbreviations	
Found County Section Corner	North South East West
Found Iron Rod	Set Iron Pipe, 1" dia.
Recorded Information	Utility Pole
Concrete Corner	Septic Vent

Sheet 1 of 1 Sheets	Job Reference Number
Drawing Name:	2022.134
2022.134	