

Plat of Survey

of

Lot 4 of Ravenswood,

a subdivision located in the Northwest 1/4 of the Southeast 1/4 of Section 31,
Town 2 North, Range 16 East, Town of Delavan, Walworth County, Wisconsin.

Surveyed for: **Mike Foley**
5940 N Ozark
Chicago, Illinois. 60631

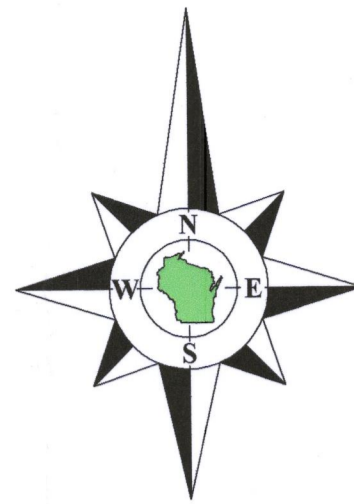

Bearings referenced to the South line of Lot 4,
recorded as East on the plat of Ravenswood.

Lot 2

Lot 3

Lot 4
Tax Parcel
FR 00004
0.409 Acre
17,837 Sq.Ft.

West ±453.4'
recorded as (West 432')

Lot 5

Lot 6

Delavan

Lake

Country Lane Drive

(20' Wide)

recorded as (N0°50'W 40')

N0°48'18"W 39.90'

39.90'

(40')

Overhead Wires

Concrete Retaining Wall

Overhead Wires

Walk

House

119.62'

Walk 0.1'

N of line

6.8'

24.3'

24.3'

24.3'

24.3'

24.3'

24.3'

24.3'

24.3'

24.3'

24.3'

24.3'

24.3'

24.3'

24.3'

24.3'

24.3'

24.3'

24.3'

24.3'

24.3'

24.3'

24.3'

24.3'

24.3'

24.3'

24.3'

24.3'

24.3'

24.3'

24.3'

24.3'

24.3'

24.3'

24.3'

24.3'

24.3'

24.3'

24.3'

24.3'

24.3'

24.3'

24.3'

24.3'

24.3'

24.3'

24.3'

24.3'

24.3'

24.3'

24.3'

24.3'

24.3'

24.3'

24.3'

24.3'

24.3'

24.3'

24.3'

24.3'

24.3'

24.3'

24.3'

24.3'

24.3'

24.3'

24.3'

24.3'

24.3'

24.3'

24.3'

24.3'

24.3'

24.3'

24.3'

24.3'

24.3'

24.3'

24.3'

24.3'

24.3'

24.3'

24.3'

24.3'

24.3'

24.3'

24.3'

24.3'

24.3'

24.3'

24.3'

24.3'

24.3'

24.3'

24.3'

24.3'

24.3'

24.3'

24.3'

24.3'

24.3'

24.3'

24.3'

24.3'

24.3'

24.3'

24.3'

24.3'

24.3'

24.3'

24.3'

24.3'

24.3'

24.3'

24.3'

24.3'

24.3'

24.3'

24.3'

24.3'

24.3'

24.3'

24.3'

24.3'

24.3'

24.3'

24.3'

24.3'

24.3'

24.3'

24.3'

24.3'

24.3'

24.3'

24.3'

24.3'

24.3'

24.3'

24.3'

24.3'

24.3'

24.3'

24.3'

24.3'

24.3'

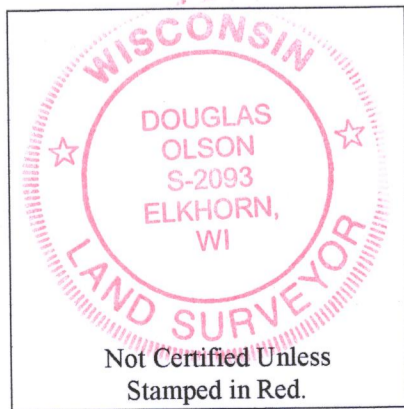

Notes:

- 1) This Plat of Survey is not certified unless signed and sealed in red ink.
- 2) This survey is subject to Wisconsin lien laws. This Plat of Survey is the notice of intent to file lien. Lien waiver required.
- 3) The Survey Date shown on this Plat of Survey is the completion date of the field work.

Notes:

The location of paved or gravel surfaces shown on this plat are approximate due to existing snow cover on the property at the time of the field survey.

There may be additional improvements or encroachments on the property which were not visible at the time of the field survey and are not shown on this plat.

Copyright © 2021 by Olson Land Surveying, LLC.

All rights reserved. No part of this survey plat may be reproduced or transmitted in any form by any means - graphic, electronic, or mechanical, including photocopying, tracing, or information storage and retrieval systems - without permission in writing from Douglas G. Olson, Olson Land Surveying, LLC.

I hereby certify that I have surveyed the above described property in compliance with Chapter A-E 7 of the Wisconsin Administrative Code and that the map hereon is correct to the best of my professional knowledge and belief and shows the size and location of the property, its exterior boundaries, the location and dimensions of all visible structures thereon, boundary fences, apparent easements and roadways and visible encroachments, if any.

This survey is made for the exclusive use of the present owners of the property, and also those who purchase, mortgage or guarantee title thereto, within one year from the date hereof.

Douglas G. Olson
Wisconsin Professional Land Surveyor - 2093

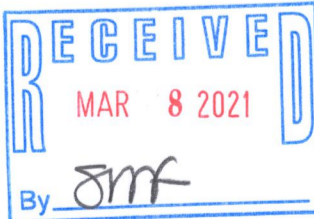

Legend of Symbols & Abbreviations

Symbol	North	East	West	South	Section	Corner
Found Iron Pipe	Found Iron Pipe	Found Iron Pipe	Found Iron Pipe	Found Iron Pipe	Found Iron Pipe	Found Iron Pipe
Found Iron Rod	Found Iron Rod	Found Iron Rod	Found Iron Rod	Found Iron Rod	Found Iron Rod	Found Iron Rod
Found Concrete	Found Concrete	Found Concrete	Found Concrete	Found Concrete	Found Concrete	Found Concrete
Recorded Information	Recorded Information	Recorded Information	Recorded Information	Recorded Information	Recorded Information	Recorded Information
Utility Pole	Utility Pole	Utility Pole	Utility Pole	Utility Pole	Utility Pole	Utility Pole
Utility Pole	Utility Pole	Utility Pole	Utility Pole	Utility Pole	Utility Pole	Utility Pole
Utility Pole	Utility Pole	Utility Pole	Utility Pole	Utility Pole	Utility Pole	Utility Pole
Concrete Surface	Concrete Surface	Concrete Surface	Concrete Surface	Concrete Surface	Concrete Surface	Concrete Surface

Sheet 1 of 1 Sheets

Drawing Name:

Job Reference Number

2020.155

2020.155

45 South Wisconsin Street | P.O. Box 322
Elkhorn, Wisconsin 53121

Telephone: (262) 773-3434

Facsimile: (262) 773-3044

Email: doug@olsonsurveying.com

Website: www.olsonsurveying.com

OLSON

LAND SURVEYING, LLC

Rural | Residential | Commercial

Survey Date: January 8, 2021.

Revisions:

Scale in Feet

1" = 20'

0' 10' 20' 40' 60'