

of

a subdivision located in the Southeast 1/4 of the Southeast 1/4 of Section 32,
Town 2 North, Range 16 East, Town of Delavan, Walworth County, Wisconsin.

Bearings referenced to the Wisconsin State Plane Coordinate System, South Zone, (NAD-27).

Coordinates are referenced to the Wisconsin State Plane Coordinate System, South Zone, (NAD-27).

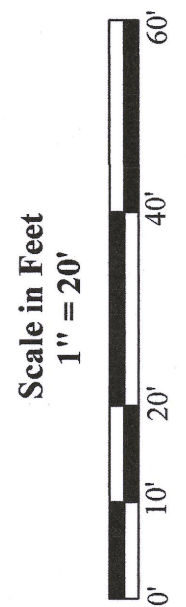

Revisions:

Elkhorn, Wisconsin, 53121
Telephone: (262) 723-3434
Facsimile: (262) 723-8044
Email: doug@olsonsurveying.com
Website: www.olsonsurveying.com

OLSON
LAND SURVEYING, LLC
Rural | Residential | Commercial

| | |
|--|--------------|
| <input type="checkbox"/> Found Concrete Monument | N North |
| <input type="checkbox"/> Found Iron Pipe | S South |
| <input type="checkbox"/> Found Iron Rod | E East |
| <input type="checkbox"/> Set Iron Pipe, 1" dia. | W West |
| <input type="checkbox"/> Recorded Information | In Bearings |
| <input type="checkbox"/> Utility Pole | " Minutes |
| <input type="checkbox"/> Utility Pedestal | " Seconds |
| <input type="checkbox"/> Asphalt Surface | In Distances |
| <input type="checkbox"/> Gravel Surface | " Feet |
| | " Inches |

Job Reference Number
2020.038

2020.038

RECEIVED
AUG 10 2020
By *omf*

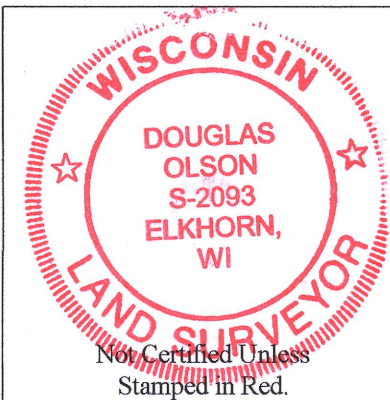

Notes:

- 1) This Plat of Survey is not certified unless signed and sealed in red ink.
- 2) This survey is subject to Wisconsin lien laws. This Plat of Survey is the notice of intent to file lien. Lien waiver required.
- 3) The Survey Date shown on this Plat of Survey is the completion date of the field work.

Copyright ©2020 by Olson Land Surveying, LLC.

All rights reserved. No part of this survey plat may be reproduced or transmitted in any form by any means - graphic, electronic, or mechanical, including photocopying, tracing, or information storage and retrieval systems - without permission in writing from Douglas G. Olson, Olson Land Surveying, LLC.

I hereby certify that I have surveyed the above described property in compliance with Chapter A-E 7 of the Wisconsin Administrative Code and that the map hereon is correct to the best of my professional knowledge and belief and shows the size and location of the property, its exterior boundaries, the location and dimensions of all visible structures thereon, boundary fences, apparent easements and roadways and visible encroachments, if any.

This survey is made for the exclusive use of the present owners of the property, and also those who purchase, mortgage or guarantee title thereto, within one year from the date hereof.

Douglas G. Olson
Wisconsin Professional Land Surveyor - 2093

FSS1-58

216-5701