

# Plat of Survey

of

## Lot 28 of The Annex to Inlet Oaks,

a subdivision located in the Southeast 1/4 of the Southeast 1/4 of Section 15, Town  
2 North, Range 16 East, Town of Delavan, Walworth County, Wisconsin.

Surveyed for:

**Dick Mann**

238 Inlet Shore Drive  
Delavan, Wisconsin. 53115

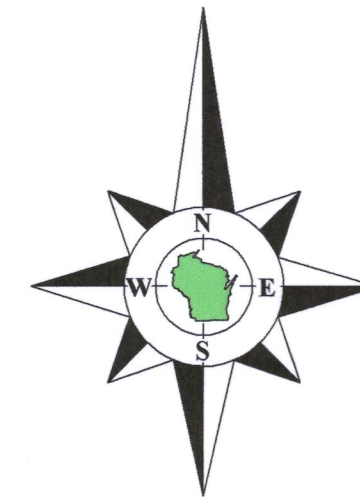

Bearings referenced to the Southerly line of Inlet Shore Drive,  
recorded as N40°30'E on the plat of The Annex to Inlet Oaks.

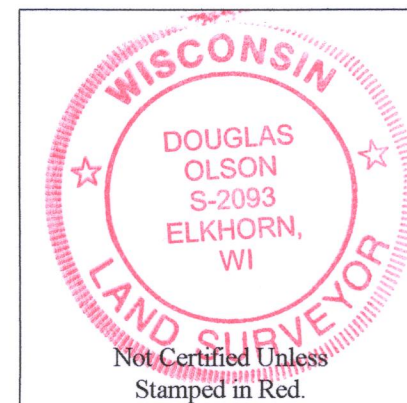

### Notes:

- 1) This Plat of Survey is not certified unless signed and sealed in red ink.
- 2) This survey is subject to Wisconsin lien laws. This Plat of Survey is the notice of intent to file lien. Lien waiver required.
- 3) The Survey Date shown on this Plat of Survey is the completion date of the field work.

Copyright ©2019 by Olson Land Surveying, LLC.

All rights reserved. No part of this survey plat may be reproduced or transmitted in any form by any means - graphic, electronic, or mechanical, including photocopying, tracing, or information storage and retrieval systems - without permission in writing from Douglas G. Olson, Olson Land Surveying, LLC.

I hereby certify that I have surveyed the above described property in compliance with Chapter A-E 7 of the Wisconsin Administrative Code and that the map hereon is correct to the best of my professional knowledge and belief and shows the size and location of the property, its exterior boundaries, the location and dimensions of all visible structures thereon, boundary fences, apparent easements and roadways and visible encroachments, if any.

This survey is made for the exclusive use of the present owners of the property, and also those who purchase, mortgage or guarantee title thereto, within one year from the date hereof.

Douglas G. Olson  
Wisconsin Professional Land Surveyor - 2093

FIA - 32A

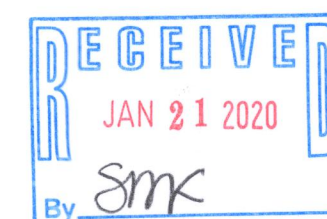

216-5651

Survey Date: November 2, 2019.  
Revisions:

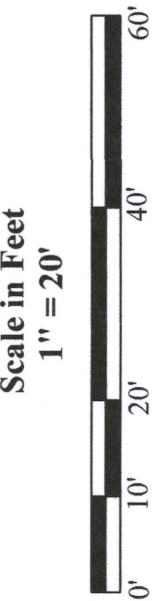

45 South Wisconsin Street | P.O. Box 322  
Elkhorn, Wisconsin. 53121  
Telephone: (262) 723-3434  
Facsimile: (262) 723-8044  
Email: doug@olsonsurveying.com  
Website: www.olsonsurveying.com

**OLSON**  
LAND SURVEYING, LLC  
Rural | Residential | Commercial

Legend of Symbols & Abbreviations	
North Arrow	North
Found Iron Pipe	Found Iron Pipe
Found Iron Rod	Found Iron Rod
Found Cut Cross	Found Cut Cross
Recorded Information	Recorded Information
Utility Pole	Utility Pole
Pedestal	Pedestal
Concrete Surface	Concrete Surface
Brick Pavers	Brick Pavers

Sheet 1 of 1 Sheets  
Drawing Name  
Job Reference Number  
2019.129  
2019.129