

of

Lot 7 in Block 1 of Potter's Subdivision,
located in Government Lot 3 in the Southwest 1/4 of Section 32, Town 2
North, Range 16 East, Town of Delavan, Walworth County, Wisconsin.

Surveyed for: **Nancy LaCursia**
4120 Dutch Mill Lane
Delavan, Wisconsin. 53115



Bearings reference to the plat
of Potter's Subdivision.

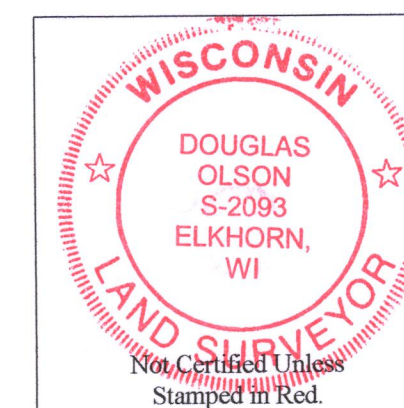

- 1) This Plat of Survey is not certified unless signed and sealed in red ink.
- 2) This survey is subject to Wisconsin lien laws. This Plat of Survey is the notice of intent to file lien. Lien waiver required.
- 3) The Survey Date shown on this Plat of Survey is the completion date of the field work.



All rights reserved. No part of this survey plat may be reproduced or transmitted in any form by any means - graphic, electronic, or mechanical, including photocopying, tracing, or information storage and retrieval systems - without permission in writing from Douglas G. Olson, Olson Land Surveying, LLC.

This survey is made for the exclusive use of the present owners of the property, and also those who purchase, mortgage or guarantee title thereto, within one year from the date hereof.

Douglas G. Olson
Wisconsin Professional Land Surveyor - 2093

Survey Date: July 2, 2019.
Revisions:

Scale in Feet
1" = 20'



A horizontal graphic scale bar with alternating black and white segments. Below the bar are markings for 0', 10', 20', 40', and 60'.

45 South Wisconsin Street | P.O. Box 322
Elkhorn, Wisconsin. 53121
Telephone: (262) 723-3434
Facsimile: (262) 723-8044
Email: doug@olsonsurveying.com
Website: www.olsonsurveying.com

OLSON
LAND SURVEYING, LLC
Rural | Residential | Commercial

Legend of Symbols & Abbreviations	
■	Found Concrete Monument
●	Found Iron Pipe
○	Recorded Information
□	Utility Pole
⊗	Utility Pedestal
⊙	Manhole
◇	PVC Pipe
▽	Gravel Surface

Sheet 1 of 1 Sheets

Drawing Name:

Job Reference Number
2019.090

2019.090