

Plat of Survey

of

Lot 2 of Certified Survey Map No. 721,

recorded in Vol. 3 of Certified Survey Maps of Walworth County on Page 228 and located in the Southeast 1/4 of the Southwest 1/4 of Section 31, Town 2 North, Range 16 East, Town of Delavan, Walworth County, Wisconsin.

Surveyed for: **Dan McCabe**
2568 County Road O South
Delavan, Wisconsin. 53115



Bearings referenced to the East line of Certified Survey Map No. 721, recorded as N0°27'20"E, which produces a bearing of N0°19'05"E on the East line of the Southwest 1/4 of Section 31-2-16. A rotation of 2°00'15" from the Wisconsin State Plane Coordinate System, South Zone, (NAD-27).

Coordinates are referenced to the Wisconsin State Plane Coordinate System, South Zone, (NAD-27).

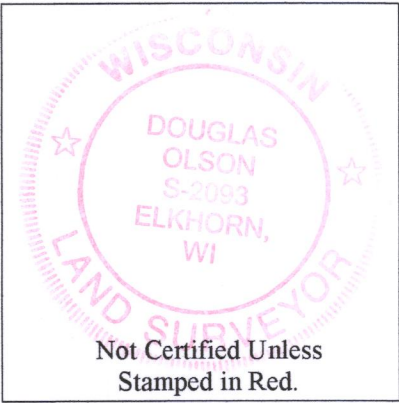
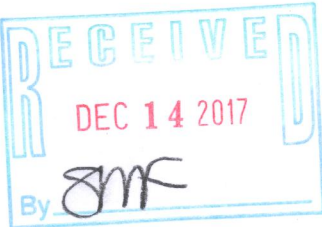

Notes:

- 1) This Plat of Survey is not certified unless signed and sealed in red ink.
- 2) This survey is subject to Wisconsin lien laws. This Plat of Survey is the notice of intent to file lien. Lien waiver required.
- 3) The Survey Date shown on this Plat of Survey is the completion date of the field work.

Copyright© 2017 by Olson Land Surveying, LLC.

All rights reserved. No part of this survey plat may be reproduced or transmitted in any form by any means - graphic, electronic, or mechanical, including photocopying, tracing, or information storage and retrieval systems - without permission in writing from Douglas G. Olson, Olson Land Surveying, LLC.

I hereby certify that I have surveyed the above described property in compliance with Chapter A-E 7 of the Wisconsin Administrative Code and that the map hereon is correct to the best of my knowledge and belief.

Douglas G. Olson
Wisconsin Professional Land Surveyor - 2093

Lot 1
C.S.M. 721

recorded as(N89°46'20"E 180.99')
N89°45'18"E 181.24'

15' Building Setback Line as shown on CSM 721

Well

Block Retaining Wall

House
No. 2568

Lot 2
Tax Parcel
FA 72100002
1.454 Acres
63,352 Sq.Ft.

Shed

Center 1/4 Corner
Section 31-2-16
(N. 217,784.00)
(E. 2,363,851.27)

East line of the Southwest 1/4 of Section 31-2-16.
recorded as(N1°41'10"W 2647.05')State Plane

S0°27'20"W 512.53'
recorded as(S0°27'20"W 512.32')

Lot 177

Lot 178

Lot 179

Lot 180

Lot 181

Lot 182

Channel Drive

(35' Wide)

Lot 183

Lot 184

Lot 185

Lot 186

Lot 187

recorded as(65.99')
66.09'

S89°59'48"W
recorded as(S89°46'20"W)

Outlot 1
C.S.M. 721

South 1/4 Corner
Section 31-2-16
(N. 215,138.14)
(E. 2,363,929.16)

Formerly Ridge Avenue
Discontinued by the Town of Delavan
Vol. 181, Page 233
Doc. No. 252064
Dated 08-20-1925.

74.93'

49.98'

20.66'

49.87'

29.31'

N0°19'05"E 439.10'

1.03'

20.66'

49.87'

29.31'

N0°19'05"E 439.10'

1.03'

20.66'

49.87'

29.31'

N0°19'05"E 439.10'

1.03'

20.66'

49.87'

29.31'

N0°19'05"E 439.10'

1.03'

20.66'

49.87'

29.31'

N0°19'05"E 439.10'

1.03'

20.66'

49.87'

29.31'

N0°19'05"E 439.10'

1.03'

20.66'

49.87'

29.31'

N0°19'05"E 439.10'

1.03'

20.66'

49.87'

29.31'

N0°19'05"E 439.10'

1.03'

20.66'

49.87'

29.31'

N0°19'05"E 439.10'

1.03'

20.66'

49.87'

29.31'

N0°19'05"E 439.10'

1.03'

20.66'

49.87'

29.31'

N0°19'05"E 439.10'

1.03'

20.66'

49.87'

29.31'

N0°19'05"E 439.10'

1.03'

20.66'

49.87'

29.31'

N0°19'05"E 439.10'

1.03'

20.66'

49.87'

29.31'

N0°19'05"E 439.10'

1.03'

20.66'

49.87'

29.31'

N0°19'05"E 439.10'

1.03'

20.66'

49.87'

29.31'

N0°19'05"E 439.10'

1.03'

20.66'

49.87'

29.31'

N0°19'05"E 439.10'

1.03'

20.66'

49.87'

29.31'

N0°19'05"E 439.10'

1.03'

20.66'

49.87'

29.31'

N0°19'05"E 439.10'

1.03'

20.66'

49.87'

29.31'

N0°19'05"E 439.10'

1.03'

20.66'

49.87'

29.31'

N0°19'05"E 439.10'

1.03'

20.66'

49.87'

29.31'

N0°19'05"E 439.10'

1.03'

20.66'

49.87'

29.31'

N0°19'05"E 439.10'

1.03'

20.66'

49.87'

29.31'

N0°19'05"E 439.10'

1.03'

20.66'

49.87'

29.31'

N0°19'05"E 439.10'

1.03'

20.66'

49.87'

29.31'

N0°19'05"E 439.10'

1.03'

20.66'

49.87'

29.31'

N0°19'05"E 439.10'

1.03'

20.66'

49.87'

29.31'

N0°19'05"E 439.10'

1.03'

20.66'

49.87'

29.31'

N0°19'05"E 439.10'

1.03'

20.66'

49.87'

29.31'

N0°19'05"E 439.10'

1.03'

20.66'

49.87'

29.31'

N0°19'05"E 439.10'

1.03'

20.66'

49.87'

29.31'

N0°19'05"E 439.10'

1.03'

20.66'

49.87'

29.31'

N0°19'05"E 439.10'

1.03'

20.66'

49.87'

29.31'

N0°19'05"E 439.10'

1.03'

20.66'

49.87'

29.31'

N0°19'05"E 439.10'

1.03'

20.66'

49.87'

29.31'

N0°19'05"E 439.10'

1.03'

20.66'

49.87'

29.31'

N0°19'05"E 439.10'

1.03'

20.66'

49.87'

29.31'

N0°19'05"E 439.10'

1.03'

20.66'

49.87'

29.31'

N0°19'05"E 439.10'

1.03'

20.66'

49.87'

29.31'

N0°19'05"E 439.10'

1.03'

20.66'

49.87'

29.31'

N0°19'05"E 439.10'

1.03'

20.66'

49.87'

29.31'

N0°19'05"E 439.10'

1.03'

20.66'

49.87'

29.31'

N0°19'05"E 439.10'

1.03'

20.66'

49.87'

29.31'

N0°19'05"E 439.10'

1.03'

20.66'

49.87'

29.31'

N0°19'05"E 439.10'

1.03'

20.66'

49.87'

29.31'

N0°19'05"E 439.10'

1.03'

20.66'

49.87'

29.31'

N0°19'05"E 439.10'

1.03'