

WORK ORDERED FOR:
BEVERLY SAMWILCHIK
BY: ROSS RITTER

FARRIS, HANSEN & ASSOCIATES, INC.
ENGINEERING - ARCHITECTURE - SURVEYING
7 RIDGWAY COURT P.O. BOX 437
ELKHORN, WISCONSIN 53121
OFFICE: (262) 723-2098 FAX: (262) 723-5886

REVISIONS

PROJECT NO.
9507
DATE:
05-03-2016
SHEET NO.
1 OF 1

PLAT OF SURVEY LOT 8 IN LAKEWOOD ESTATES SUBDIVISION

LOCATED IN THE NE 1/4 OF THE SE 1/4 SECTION 21
TOWN 2 NORTH, RANGE 16 EAST
WALWORTH COUNTY, WISCONSIN



LEGEND

- = FOUND IRON PIPE STAKE
- = SET IRON REBAR STAKE
- (XXX) = RECORDED AS

MAP SCALE IN FEET ORIGINAL 1" = 20'

NOTE: COPIES OF THIS MAP TO WHICH THE FOLLOWING CERTIFICATE WILL APPLY SHOW THE SURVEYOR'S ORIGINAL SEAL AND SIGNATURE IN RED INK. COPIES BY ANY OTHER MEANS MAY HAVE ALTERATIONS WHICH DO NOT REPRESENT THE SURVEYOR'S WORK PRODUCT.

I HEREBY CERTIFY THAT THE ABOVE DESCRIBED PROPERTY HAS BEEN SURVEYED UNDER MY DIRECTION AND THAT THE ABOVE MAP IS A TRUE REPRESENTATION THEREOF AND SHOWS THE SIZE AND LOCATION OF THE PROPERTY AND ITS EXTERIOR BOUNDARIES. THIS SURVEY IS MADE FOR THE USE OF THE PRESENT OWNERS OF THE PROPERTY, AND ALSO THOSE WHO PURCHASE, MORTGAGE, OR GUARANTEE THE TITLE THERETO WITHIN ONE YEAR FROM THE DATE HEREOF.

DATED: MAY 3, 2016

Peter S. Gordon
PETER S. GORDON P.L.S. 2101

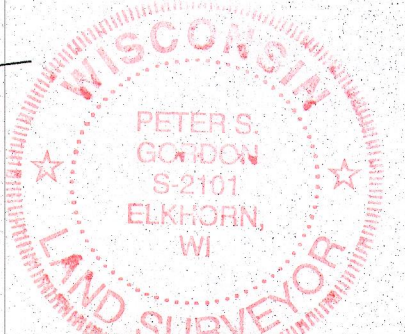

FLE-8

216 5303