

PLAT OF SURVEY

LOTS 1 & 2 OF CERTIFIED SURVEY MAP NO. 3933
RECORDED IN VOL. 24 ON PG. 102 AS DOC. NO. 675536
LOCATED IN PART OF THE SOUTHEAST 1/4 OF THE NORTHEAST 1/4
OF SECTION 36, TOWN 2 NORTH, RANGE 16 EAST,
TOWN OF DELAVAN, WALWORTH COUNTY, WISCONSIN

PARCEL 1:
(A) Lot 1 of Certified Survey Map No. 3933 recorded in the office of the Register of Deeds for Walworth County, Wisconsin on May 4, 2006, in Volume 24 of Certified Survey Maps, on Page 102, as Document No. 675536, located in the SE 1/4 of the NE 1/4 of Section 36, Town 2 North, Range 16 East, Town of Delavan, Walworth County, Wisconsin.

(B) Together with a 50' easement for access and egress as shown on Certified Survey Map No. 3933 recorded May 4, 2006 as Document No. 675536.

(C) An undivided interest in a parcel of land located in the NW 1/4 of Section 36, T2N, R16E, being an undeveloped roadway known as Mielke Lane as described in deed recorded July 13, 2006 as Document No. 682271, and as set forth on Certified Survey Map No. 1700, recorded June 2, 1988 as Document No. 162976 and as set forth on Certified Survey Map No. 4214, recorded January 16, 2009 as Document No. 752920, and as further described in Court Order recorded February 10, 2009 as Document No. 754722.

Tax Key No.: FA393300001

PARCEL 2: Lot 2 of Certified Survey Map No. 3933 recorded in the office of the Register of Deeds for Walworth County, Wisconsin on May 4, 2006, in Volume 24 of Certified Survey Maps, on Page 102, as Document No. 675536, located in the SE 1/4 of the NE 1/4 of Section 36, Town 2 North, Range 16 East, Town of Delavan, Walworth County, Wisconsin.

Tax Key No.: FA393300002

UNPLATTED LANDS.

LOT 1
82,637 S.F.
(1.44 AC.)

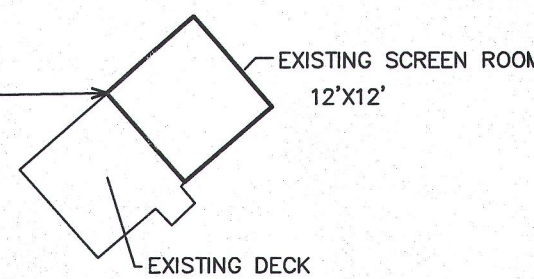

WEST LINE OF THE EAST 1/2 OF THE NE 1/4 OF SEC. 36-2-16

MIELKE LANE
40' WIDE PRIVATE DRIVE
UNIMPROVED
SEE COURT ORDER FILED
CASE #06-CV-00607

C.S.M.
1700

LOT 2
41,192 S.F.
(0.95 AC.)

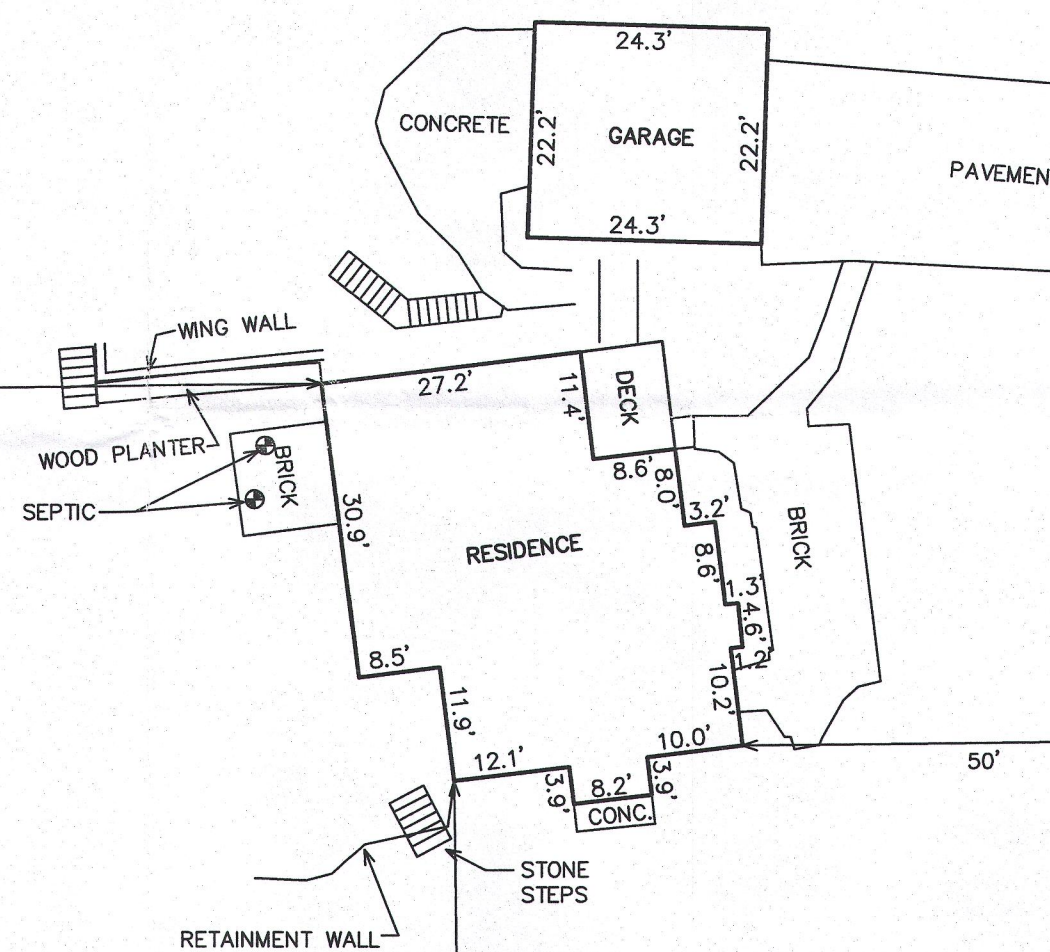

UNPLATTED LANDS.

CIRCLE DRIVE
66' WIDE R.O.W.

NORTHEAST CORNER
SECTION 36-2-16
(221,180.26 N.)
(2,392,924.14 E.)

EAST 1/4 CORNER
SECTION 36-2-16
(218,543.30 N.)
(2,392,958.91 E.)

- LEGEND
- = FOUND IRON PIPE STAKE, 1 3/8" O.D.
 - = FOUND IRON REBAR STAKE, 3/4" DIA.
 - ▣ = FOUND CONCRETE COUNTY MONUMENT W/ BRASS CAP
 - {XXX} = RECORDED AS

NOTE: COPIES OF THIS MAP TO WHICH THE FOLLOWING CERTIFICATE WILL APPLY SHOW THE SURVEYOR'S ORIGINAL SEAL AND SIGNATURE IN RED INK. COPIES BY ANY OTHER MEANS MAY HAVE ALTERATIONS WHICH DO NOT REPRESENT THE SURVEYOR'S WORK PRODUCT.

I HEREBY CERTIFY THAT THE ABOVE DESCRIBED PROPERTY HAS BEEN SURVEYED UNDER MY DIRECTION AND THAT THE ABOVE MAP IS A TRUE REPRESENTATION THEREOF AND SHOWS THE SIZE AND LOCATION OF THE PROPERTY, ITS EXTERIOR BOUNDARIES, THE LOCATION OF ALL VISIBLE STRUCTURES, AND DIMENSIONS OF ALL PRINCIPLE BUILDINGS THEREON, BOUNDARY FENCES, APPARENT EASEMENTS, ROADWAYS, AND VISIBLE ENCROACHMENTS, IF ANY. THIS SURVEY IS MADE FOR THE USE OF THE PRESENT OWNERS OF THE PROPERTY, AND ALSO THOSE WHO PURCHASE, MORTGAGE, OR GUARANTEE THE TITLE THERETO WITHIN ONE YEAR FROM THE DATE HEREOF.

DATED: JUNE 1, 2016

PETER S. GORDON

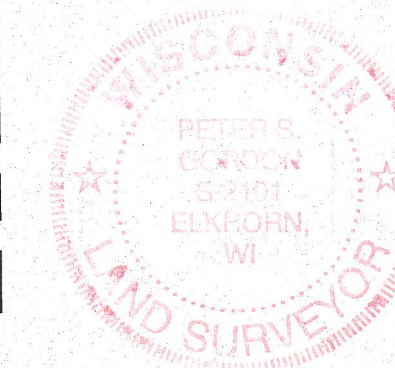
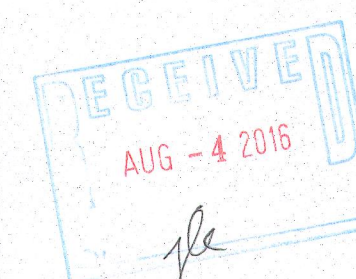

MAP SCALE IN FEET ORIGINAL 1" = 20'

WORK ORDERED BY -
HORAN ELIZABETH MARY TRUST
C/O KEEFE REAL ESTATE
1000 GENERAL AVENUE
MILWAUKEE, WI 53233

FARRIS, HANSEN & ASSOCIATES, INC.
ENGINEERING ARCHITECTURE - SURVEYING

REVISION

PROJECT
66

DATE
03/09

SHEET NO.
1 OF 1