

PREPARE FOR:
MARY KILKENNY
KEEFE REAL ESTATE
DEHAVAN, WI.

PLAT OF SURVEY

- OF -

PATHFINDER SURVEYING INC.
(formerly)
J.K. SURVEYING INC.
P.O BOX 322
LAKE GENEVA, WI. 53147
WWW.PATHFINDERSURVEYING.NET
262-248-8303

LOT 10 WOODLAND SHORES, BEING A PART OF THE NE 1/4, SE 1/4
AND SW 1/4 OF THE SE 1/4 OF SECTION 20 AND A PART OF THE NW 1/4
AND SW 1/4 OF THE SW 1/4 OF SECTION 21, ALL IN TOWN 2 NORTH, RANGE
16 EAST, TOWN OF DELAVAN, WALWORTH COUNTY, WISCONSIN.

DELAVAN LAKE

shoreline September 2014

TIMBER STEPS

30' wide drainage easement
to the town of Delavan
per Woodland Shores Plat

N 49°21'19" E
center line 30' sanitary sewer easement
per record subdivision plat

N 53°39'25" E 110.72'
(N 53°41'24" E 110.70')

wood garden
fence

corner of
asphalt driveway

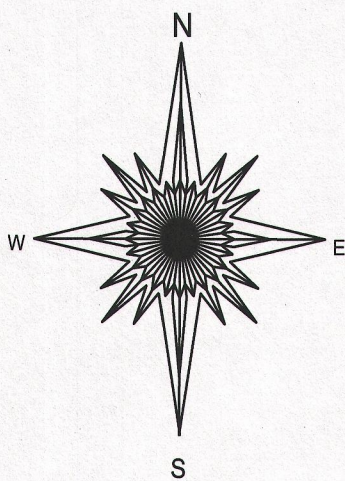

25 0 25 50

BASIS OF BEARING OF THIS PLAT: THE WEST LINE
OF LOT 10 WAS ASSUMED TO BEAR N23°50'00" W
AS SHOWN ON THE RECORD PLAT.

() = recorded as

□ = found iron bar

○ = found iron pipe

● = set iron pipe

■ = set iron bar

SCALE 1" = 25'

JOB # 14-214

TAX ID #
FWLS 00010

I hereby certify that I have surveyed the above- described property and the
above map is a is a true representation thereof and shows the size and
location of the property, its exterior boundaries, the location and
dimensions of all structures thereon, fences, apparant easements and
roadways and visible encroachments if any.

This survey is made for the present owners of the property, and those who
purchase, mortgage, or guarantee the title thereto, within one year from
the date hereof.

DATED THIS 18TH DAY OF SEPTEMBER, 2014.

BLUE HERON DRIVE
(platted as Woodland Shores Drive 66' wide)

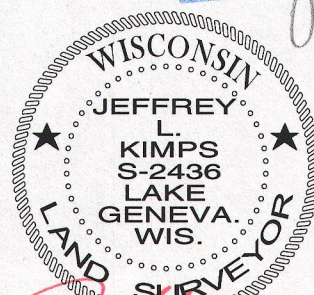

JEFFREY L KIMPS S - 2436
Wisconsin Registered Land Surveyor
(original if signed in red)

FWL8-10

216-5166