

Bearings reference to previous surveys of record.

# Property Exhibit

of

## Part of the Outlot of Krumhaar's 2nd Addition to Ravenswood,

a subdivision located in the Southeast 1/4 of Section 31, Town 2 North, Range 16 East, Town of Delavan, Walworth County, Wisconsin.

### Legal Description of Proposed Ingress & Egress Easement

A ingress & egress easement on a portion of the Outlot of Krumhaar's 2nd Addition to Ravenswood, a subdivision located in the Southeast 1/4 of Section 31, Town 2 North, Range 16 East, Town of Delavan, Walworth County, Wisconsin, described as follows: Begin at an iron pipe marking the Northwest corner of said Outlot; thence South 88°47'32" East, along the North line of said Outlot, 30.00 feet; thence South 0°25'30" West 10.00 feet; thence North 88°47'32" West 30.00 feet to a point on the West line of said Outlot; thence North 0°25'30" East, along said West line, 10.00 feet to the Point of Beginning.

Surveyed for: **Ravenswood Community Organization, Inc.**

c/o

**Law Offices of Anthony A. Coletti, S.C.**

101 Evergreen Parkway \* Unit 3  
Elkhorn, Wisconsin. 53121

**Park**

**Outlot**

**Tax Parcel  
FRA2 00064**

Copyright 2012 by Jensen & Olson Land Surveying, LLC.

All rights reserved. No part of this survey plat may be reproduced or transmitted in any form by any means - graphic, electronic, or mechanical, including photocopying, tracing, or information storage and retrieval systems - without permission in writing from Douglas G. Olson, Jensen & Olson Land Surveying, LLC.

I, Douglas G. Olson, Wisconsin Registered Land Surveyor, do hereby certify that this survey was performed by me, or under my direction in full compliance with the owner's/agent's instructions and Chapter A-E 7 of the Wisconsin Administrative Code "Minimum Standards for Property Surveys"; and that this map is an accurate representation thereof to the best of my knowledge and belief.

Douglas G. Olson  
Wisconsin Registered Land Surveyor - 2093

**Masche Drive**  
(20' Wide)

**Forest Drive**  
(20' Wide)

**Walk**  
(10' Wide)

### Notes:

- 1) This survey plat is not certified unless signed and sealed in red ink.
- 2) This survey is subject to Wisconsin lien laws. This Plat of Survey is the notice of intent to file lien. Lien waiver required.

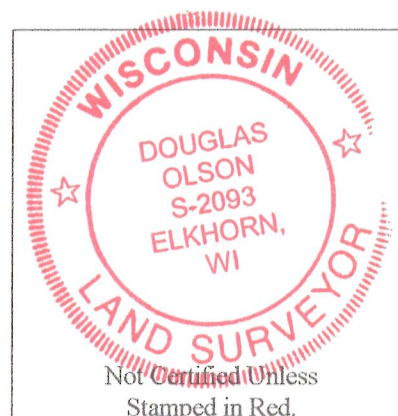

Survey Date: June 5, 2012.  
Revisions:

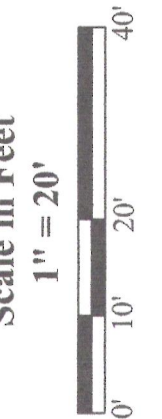

**Jensen & Olson Land Surveying, LLC**

45 South Wisconsin Street \* P.O. Box 322 \* Elkhorn, Wisconsin. 53121  
Telephone: (262) 723-3434 \* Facsimile: (262) 723-8044  
Email: jensen.olson@elknet.net

**Legend**  
Found Iron Pipe  
Found Iron Rod  
( ) Recorded Information  
O Manhole  
Asphalt Surface  
Gravel Surface

**Sheet 1 of 1 Sheets**  
Drawing Name: Our 16-2012054-2012054 Exhibit.dwg  
**Job Reference Number**  
**2012.054**

**2012.054**

FRA2-04

2116-4969