

of

being subdivisions located in the Southeast 1/4 of Section 31, Town 2 North, Range 16 East, Town of Delavan, Walworth County, Wisconsin.

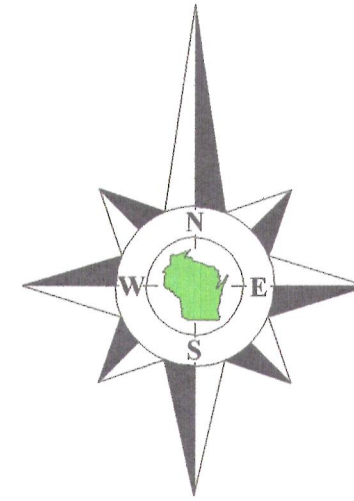

Bearings reference to the
plat of Ravenswood..

830 East Geneva Street
Delavan, Wisconsin. 53115

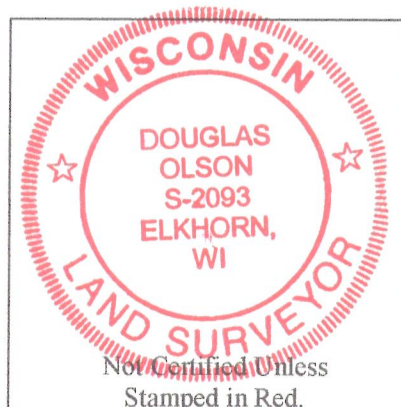

- 1) This survey plat is not certified unless signed and sealed in red ink.
- 2) This survey is subject to Wisconsin lien laws. This Plat of Survey is the notice of intent to file lien. Lien waiver required.

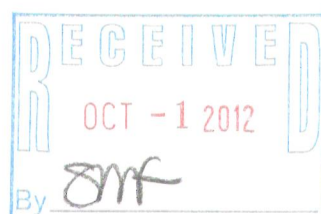

All rights reserved. No part of this survey plat may be reproduced or transmitted in any form by any means - graphic, electronic, or mechanical, including photocopying, tracing, or information storage and retrieval systems - without permission in writing from Douglas G. Olson, Jensen & Olson Land Surveying, LLC.

This survey is made for the exclusive use of the present owners of the property, and also those who purchase, mortgage or guarantee title thereto, within one year from the date hereof.

Douglas G. Olson
Wisconsin Registered Land Surveyor - 2093

2012.015

∅ Found Iron Pipe
 ● Found Iron Rod
 ○ Set Iron Pipe
 ⊗ Set Spindle
 () Recorded Information
 ⊗ Utility Pole
 ⊠ Utility Pedestal
 ▨ Asphalt Surface
 ▩ Concrete Surface
 ▩ Gravel



Email: jensen.olson@elknet.net

Survey Date: March 13, 2012.
Revisions:

FRA-25 FR-17

216-49104