

PREPARE FOR:
RYAN SIMONS
KEEFE REAL ESTATE
DELAVAN, WI.

PLAT OF SURVEY

- OF -

LOTS 26 and 27, BLOCK 18 DELAVAN LAKE VIEW CREST
SUBDIVISION, A SUBDIVISION LOCATED IN SECTION 31 TOWN 2
NORTH, RANGE 16 EAST OF THE FOURTH PRINCIPLE MERIDIAN,
TOWN OF DELAVAN, WALWORTH COUNTY, WISCONSIN

PATHFINDER SURVEYING INC.
(formerly)
J.K. SURVEYING INC.
P.O BOX 322
LAKE GENEVA, WI. 53147
WWW.PATHFINDERSURVEYING.NET
262-248-8303

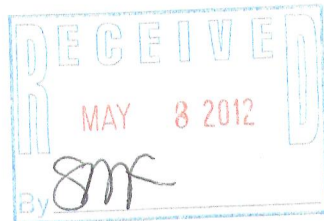

() = recorded as

□ = found iron bar

○ = found iron pipe

● = set iron pipe

■ = set iron bar

SCALE 1" = 20'

JOB #12-40

TAX ID #FDLV00167 &
FDLV00168

NOTE : BEARINGS ARE REFRENED FROM PREVIOUS SURVEY OF RECORD

"I hereby certify that I have surveyed the above described property and that the above map, to the best of my knowledge and belief, is a true representation thereof and shows the size and location of all visible structures, apparent easements and encroachments if any."
This survey is made for the present owners of the property, and those who purchase, mortgage, or guarantee the title thereto, within one year from the date hereof.

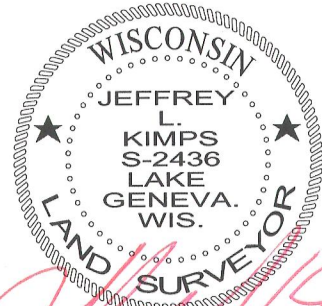

JEFFREY L KIMPS S - 2436
Wisconsin Registered Land Surveyor
(original if signed in red)

DATED THIS THE 9th DAY OF APRIL 2012

216-4938