

# Plat of Survey

## of Lots 7 and 8 in Block 2 of Robbins Subdivision,

located in the Southwest 1/4 of  
Section 32, Town 2 North, Range  
16 East, Town of Delavan,  
Walworth County, Wisconsin.

Surveyed for:  
**D.J.C. Construction, LLC**  
W6774 Brick Church Road  
Walworth, Wisconsin. 53184

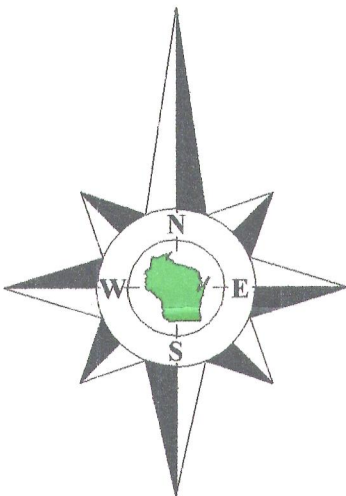
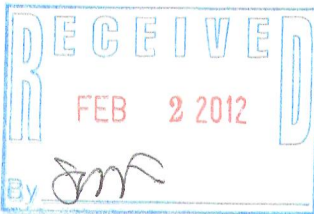

Bearings referenced to the East line  
of Carol Street, assumed as North.

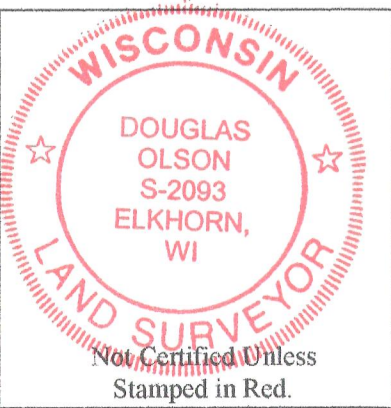

- Notes:**
- 1) This survey plat is not certified unless signed and sealed in red ink.
  - 2) This survey is subject to Wisconsin lien laws. This Plat of Survey is the notice of intent to file lien. Lien waiver required.

I, Douglas G. Olson, Wisconsin Registered Land Surveyor, do hereby certify that this survey was performed by me, or under my direction in full compliance with the owner's/agent's instructions and Chapter A-E 7 of the Wisconsin Administrative Code "Minimum Standards for Property Surveys"; and that this map is an accurate representation thereof to the best of my knowledge and belief.

Douglas G. Olson  
Wisconsin Registered Land Surveyor - 2093

Copyright 2011 by Jensen & Olson Land Surveying, LLC.

All rights reserved. No part of this survey plat may be reproduced or transmitted in any form by any means - graphic, electronic, or mechanical, including photocopying, tracing, or information storage and retrieval systems - without permission in writing from Douglas G. Olson, Jensen & Olson Land Surveying, LLC.

2011.005

Sheet 1 of 1 Sheets

Drawing Name: t2nr16e-2011005-2011005Plat.scj

Job Reference Number

2011.005

### Legend

- Found Iron Pipe
- Found Iron Rod
- Set Iron Rod
- Set Wood Stake
- Recorded Information
- Utility Pole
- Utility Pedestal
- Asphalt Surface
- Concrete Surface



**Jensen & Olson Land Surveying, LLC**

45 South Wisconsin Street \* P.O. Box 322 \* Elkhorn, Wisconsin. 53121

Telephone: (262) 723-3434 \* Facsimile: (262) 723-8044

Email: jensen.olson@elknet.net

Scale in Feet  
1" = 10'

0' 5' 10' 20'

Survey Date: March 4, 2011.

Revisions: No. 1 - Set Rod  
No. 2 - Adjacent Houses  
No. 3 - Addition 1' West

FRO 9

216-4919