

FEW-3

Plat of Survey

of
Lot 3 of Elkwood,
a subdivision located in the Northeast 1/4 of Section 13, Town 2 North,
Range 16 East, Town of Delavan, Walworth County, Wisconsin.

Surveyed for: **Estate of William Myers**

4963 Mound Road
Elkhorn, Wisconsin. 53121

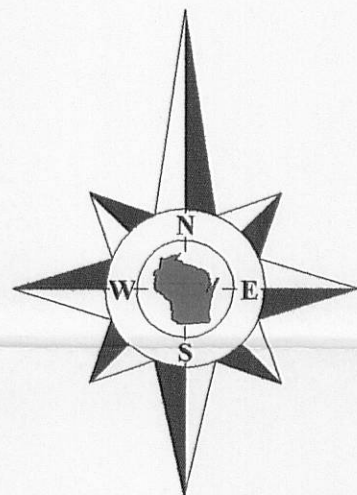

Bearings referenced to the plat of Elkwood.

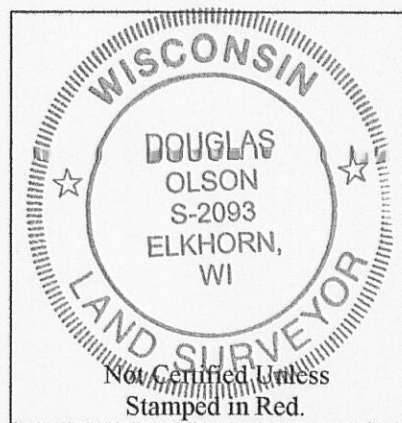

Notes:

- 1) This survey plat is not certified unless signed and sealed in red ink.
- 2) This survey is subject to Wisconsin lien laws. This Plat of Survey is the notice of intent to file lien. Lien waiver required.

Copyright 2011 by Jensen & Olson Land Surveying, LLC.

All rights reserved. No part of this survey plat may be reproduced or transmitted in any form by any means - graphic, electronic, or mechanical, including photocopying, tracing, or information storage and retrieval systems - without permission in writing from Douglas G. Olson, Jensen & Olson Land Surveying, LLC.

I, Douglas G. Olson, Wisconsin Registered Land Surveyor, do hereby certify that this survey was performed by me, or under my direction in full compliance with the owner's/agent's instructions and Chapter A-E 7 of the Wisconsin Administrative Code "Minimum Standards for Property Surveys"; and that this map is an accurate representation thereof to the best of my knowledge and belief.

Douglas G. Olson
Wisconsin Registered Land Surveyor - 2093

Mound Road

(66' Wide)

North line of the Northeast 1/4 of Section 13-2-16.

(East 107.25')

East 107.28'

2" dia. pipe

Northwest Corner
of Elkwood Subd.

(107.25')

214.58'

(107.25')

Found pipe leaning
0.24' N. - Reset.

Found pipe lying
down - Reset

107.54'
(107.25') Plat
(107.54') Between found pipe
Abell survey 1993.

Lot 2

(N0°10'W 373.16')
N0°09'43"W 373.46'

Lot 3
Tax Parcel
FEW 00003
0.920 Acres
40,060 Sq.Ft.

Lot 4

(N0°10'W 373.16')
N0°09'32"W 373.45'

127.92'

90.27'

82.53'

72.73'

N89°59'42"E 107.26'
(East 107.25')

Lot 12

Lot 13

Lot 14

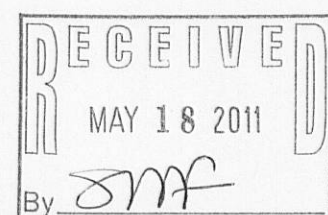

Survey Date: March 25, 2011.
Revisions:

Scale in Feet
1" = 30'
0' 15' 30' 60'

Jensen & Olson Land Surveying, LLC
45 South Wisconsin Street * P.O. Box 322 * Elkhorn, Wisconsin. 53121
Telephone: (262) 723-3434 * Facsimile: (262) 723-8044
Email: jensen.olson@elknet.net

Legend
Found Iron Pipe
Found Iron Rod
Set Iron Rod
Recorded Information
Concrete Cover
PVC Pipe
Utility Pedestal
Asphalt Surface

Sheet 1 of 1 Sheets
Drawing Name: C:\m\2010\24-2010\24pln1.swg
Job Reference Number
2010.124

2010.124

FEW-3

216-4859