

# Plat of Survey

of

Lands described in a Quit Claim Deed recorded May 31, 2001 in Vol. 681 on Page 3854 as Document No. 472043 as shown below:

Lot 11 of Willow Point Park, Delavan Lake, Walworth County, Wisconsin. Also a part of Lot 3 of the Addition to Willow Point Park according to a plat thereof of record in the Office of the Register of Deed in and for Walworth County, Wisconsin in Volume 9 of Plats on page 94 described as follows, to-wit: Beginning at the Southeast corner of said Lot 3 and running Southwesterly along the South line of said Lot, 6 1/2 feet to a point, thence running Northwesterly to the Northeast corner of said Lot 3, thence Southeasterly along the East line of Lot 3 to the point of beginning.

Surveyed for: **Chad & Kathy Kort**  
2730 Willow Point Drive  
Delavan, Wisconsin. 53115

Lot 10  
Willow Point Park

Lot 11

House  
No. 2730

Lot 3  
Addition to  
Willow Point Park

Tax Parcel  
FWI 00009

Total Area  
0.286 Acre  
12,447 Sq.Ft.

Shed

Tax Parcel  
FWI 00003A

Deck

"Park"  
Addition to  
Willow Point Park

Delavan

Lake

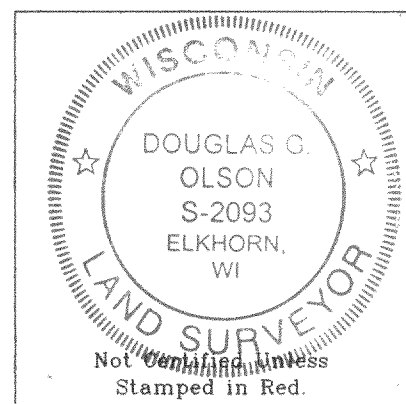

Notes: 1) This survey plat is not certified unless signed and sealed in red ink.

2) This survey is subject to Wisconsin lien laws. This Plat of Survey is the notice of intent to file lien. Lien waiver required.

Copyright © 2005 by Jensen & Olson Land Surveying, LLC.

All rights reserved. No part of this survey plat may be reproduced or transmitted in any form by any means - graphic, electronic, or mechanical, including photocopying, tracing, or information storage and retrieval systems - without permission in writing from Douglas G. Olson, Jensen & Olson Land Surveying, LLC.

I, Douglas G. Olson, Wisconsin Registered Land Surveyor, do hereby certify that this survey was performed by me or under my direction in full compliance with the owner's/agent's instructions and Chapter A-E 7 of the Wisconsin Administrative Code "Minimum Standards for Property Surveys", and that this map is an accurate representation thereof to the best of my knowledge and belief.

Douglas G. Olson  
Wisconsin Registered Land Surveyor - 2093

Survey Date: June 1, 2005.  
Revisions:

Scale in Feet  
1" = 15'  
0 7.5 15 30

Jensen & Olson Land Surveying, LLC  
45 South Wisconsin Street  
Elkhorn, Wisconsin, 53121  
Telephone (262) 723-3434  
Facsimile (262) 723-8044

Legend  
○ Found Iron Pipe  
● Found Iron Rod  
○ Set Spike  
[ ] Record Information Subd. Plat  
[ ] Record Information Dunham 95  
[ ] Utility Pole  
[ ] Asphalt Surface  
[ ] Concrete

Sheet 1 of 1 Sheets  
Job Reference Number  
2005.077  
2005.077

FWI-9

216 - 216 - 4200