

1140 SEQUOIA STREET • DELAVAN, WISCONSIN 53115  
262-728-6737

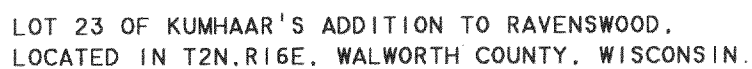

ORDERED BY: TOM WOLF  
3901 N. LINCOLN  
CHICAGO, WI 60613

I HEREBY CERTIFY THAT I HAVE SURVEYED THE ABOVE DESCRIBED PROPERTY AND THAT THE ABOVE MAP IS A TRUE REPRESENTATION THEREOF AND SHOWS THE SIZE AND LOCATION OF THE PROPERTY, ITS EXTERIOR BOUNDARIES, THE LOCATION OF ALL VISIBLE STRUCTURES AND DIMENSIONS OF ALL PRINCIPAL BUILDINGS THEREON, BOUNDARY FENCES, APPARENT EASEMENTS, ROADWAYS AND VISIBLE ENCROACHMENTS, IF ANY, TO THE BEST OF MY KNOWLEDGE AND BELIEF.

THIS SURVEY IS MADE FOR THE USE OF THE PRESENT OWNERS OF THE PROPERTY, AND ALSO THOSE WHO PURCHASE, MORTGAGE, OR GUARANTEE THE TITLE THERETO WITHIN ONE (1) YEAR FROM DATE HEREON.

FROM DATE HEREON.

*David F. Abell*

DAVID F. ABELL  
WISCONSIN REGISTERED LAND SURVEYOR. S-1596





April 22, 2005

DATE \_\_\_\_\_ JOB NUMBER - 05043  
NOTE: THIS IS NOT A CERTIFIED COPY UNLESS SEALED.

 $\mathcal{N}$ 

SCALE 1" = 20'

### LEGEND

-  - IRON PIPE FOUND  
 - IRON ROD FOUND  
 - SQUARE IRON ROD FOUND  
WP - WOOD PORCH  
WS - WOOD STOOP  
 - WOOD FENCE  
( ) - RECORDED AS

FRA 60020

216-4022