

# ABELL SURVEYING & MAPPING

1140 SEQUOIA STREET • DELAVAN, WISCONSIN 53115  
262-728-6737

LOT 1

40.1'

466.20'

N 88°00'21" E

NOTE: BEARINGS ARE REFERENCED TO  
CERTIFIED SURVEY MAP NO. 3514.

N



SCALE 1"=80'

## LEGEND

- - IRON PIPE FOUND
- - CONCRETE MONUMENT FOUND
- △ - UTILITY POLE
- - UTILITY PED.
- - GUY WIRE
- - OVERHEAD UTILITY LINES
- \*—\*— - WIRE FENCE
- \*\*—\*\*— - CHAINLINK FENCE
- ▲ - SOIL BORING

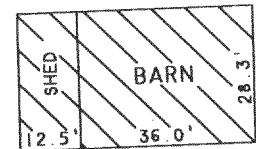

DETAIL SCALE 1"=40'

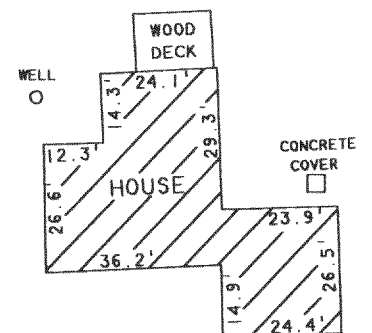

CURRENT ACCESSORY STRUCTURES AREA:  
BARN 1019 SQ. FT.  
SHED ATTACHED TO BARN 354 SQ. FT.  
EXISTING HOUSE 1954 SQ. FT.

TOTAL CURRENT ACCESSORY STRUCTURE AREA: 3327 SQ. FT.

PROPOSE REMOVING SHED ON BARN TO REDUCE  
TOTAL ACCESSORY STRUCTURE AREA TO 2973 SQ. FT.  
TO COMPLY WITH THE C-2 ACCESSORY STRUCTURE AREA  
ALLOWED.

SEE DETAIL AT RIGHT  
FOR DIMENSIONS

HOUSE

GRAVEL DRIVE

S & D TOWNLINE ROAD

SOUTH 1/4 CORNER  
SECTION 31-2-16

## PLAT OF SURVEY OF

LOT 2, CERTIFIED SURVEY MAP NO. 3514, LOCATED  
IN THE SOUTHWEST 1/4 OF THE SOUTHWEST 1/4 OF  
SECTION 31, T2N, R16E, WALWORTH COUNTY, WISCONSIN.

I HEREBY CERTIFY THAT I HAVE SURVEYED THE ABOVE DESCRIBED PROPERTY AND THAT THE  
ABOVE MAP IS A TRUE REPRESENTATION THEREOF AND SHOWS THE SIZE AND LOCATION OF  
THE PROPERTY, ITS EXTERIOR BOUNDARIES, THE LOCATION OF ALL VISIBLE STRUCTURES  
AND DIMENSIONS OF ALL PRINCIPAL BUILDINGS THEREON, BOUNDARY FENCES, APPARENT  
EASEMENTS, ROADWAYS AND VISIBLE ENCROACHMENTS, IF ANY, TO THE BEST OF MY  
KNOWLEDGE AND BELIEF.

THIS SURVEY IS MADE FOR THE USE OF THE PRESENT OWNERS OF THE PROPERTY, AND ALSO  
THOSE WHO PURCHASE, MORTGAGE, OR GUARANTEE THE TITLE THERETO WITHIN ONE (1) YEAR  
FROM DATE HEREON.

*David F. Abell*

DAVID F. ABELL  
WISCONSIN REGISTERED LAND SURVEYOR, S-1596

April 19, 2005

DATE: April 19, 2005 JOB NUMBER: 02140C  
NOTE: THIS IS NOT A CERTIFIED COPY UNLESS SEALED.

ORDERED BY: COOK CONSTRUCTION  
7242 S & D TOWNLINE ROAD  
DELAVAN, WI 53115

REVISED: MAY 3, 2005  
ORDERED BY: GREG GOETHAL  
2540 N. SHORE DRIVE  
DELAVAN, WI 53115

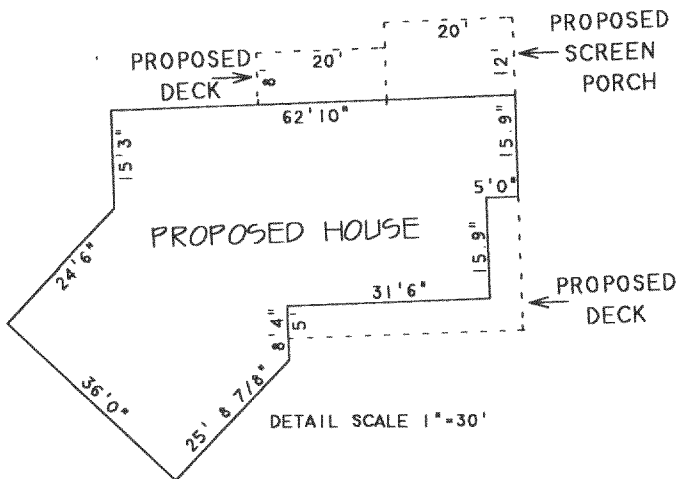

DETAIL SCALE 1"=30'