

# ABERNATHY and ASSOCIATES

Kenneth B. Abernathy Jr.

Wisconsin Registered Land Surveyor S-1594

W4056 BRAY RD.  
ELKHORN, WI. 53121  
PHONE: (262) 723-4260 (OFFICE)  
(262) 723-7209 (FAX)  
Email: abernathy@elknet.net

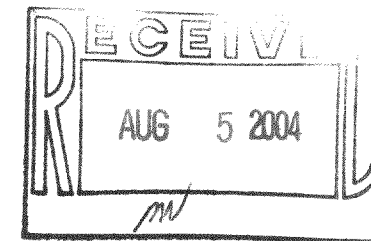

## PLAT OF SURVEY

Lot 22, Block 1, Inlet Oaks Subdivision No. 3  
located in Section 22, Town 2 North, Range  
16 East, Walworth County, Wisconsin.

FIRST

40' WIDE

STREET

BLOCK

1

Ordered By: Ray Rios - Rios Enterprises  
334 Depot St.  
Antioch, IL 60002

Owner: Kenneth M. Kielbasa  
6227 W. Hunnington  
Chicago, IL 60648

Lot 23

Lot 22

7039 s.f.

Lot 21

### Legend

- ⊗ FOUND IRON PIPE
- FOUND IRON ROD
- ⊠ FOUND BRASS CAPPED MONUMENT
- FOUND CONCRETE MONUMENT
- + CHISEL CUT IN CONCRETE
- SET IRON ROD, 24" LONG, WEIGHING 1.5 LBS./LINEAL FT., 3/4" DIA.
- SET IRON ROD, 30" LONG, WEIGHING 4.5 LBS./LINEAL FT., 1-11/16" DIA.
- ( x x ) RECORDED AS DIMENSION
- x — x — EXISTING FENCE

SCALE: 1" = 20 FEET

"I hereby certify that the above described property has been surveyed by me or under my direction and that the above map is a true representation thereof and shows the size and location of the property, its exterior boundaries, the location of all visible structures and dimensions of all principal buildings thereon, boundary fences, apparent easements, roadways and visible encroachments, if any."

"This survey is made for the use of the present owners of the property, and also those who purchase, mortgage, or guarantee the title thereto within one year from the date hereof."

*Kenneth B. Abernathy, Jr.*

KENNETH B. ABERNATHY, JR.  
WISCONSIN REGISTERED LAND SURVEYOR,  
S-1594

Date: JULY 7, 2003 Job No. 03.606

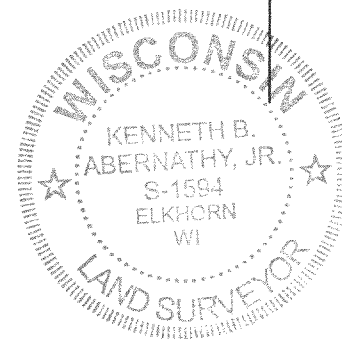

INT. ANGLE  
89°28'40"

REVISED APRIL 30, 2004 TO SHOW REVISED DECK

FIN 00018

216-3789