

ABELL SURVEYING & MAPPING

1140 SEQUOIA STREET • DELAVAN, WISCONSIN 53115
262-728-6737

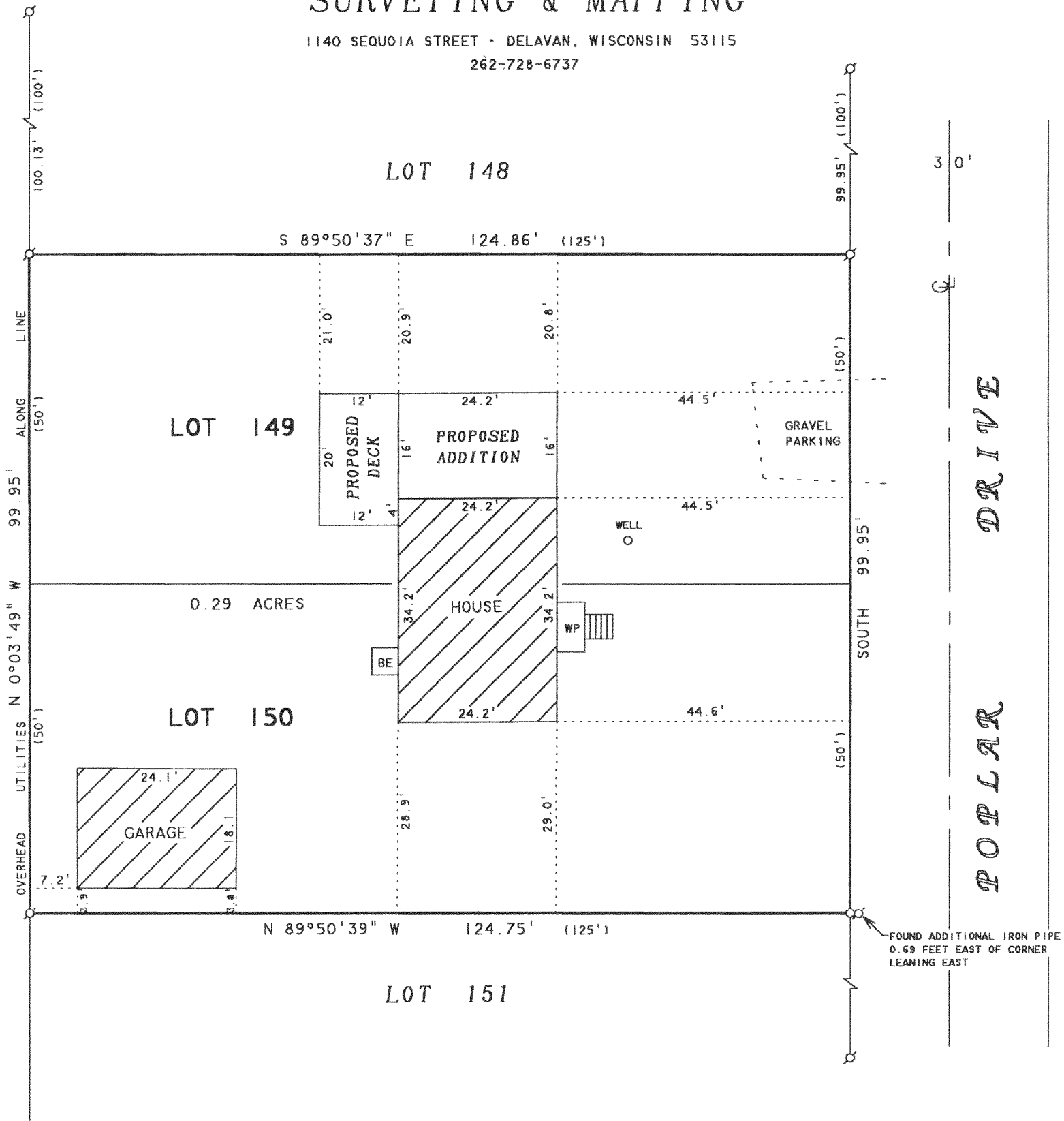

PLAT OF SURVEY OF

LOTS 149 AND 150, LAKE DELAVAN HIGHLANDS, T2N.R16E,
WALWORTH COUNTY, WISCONSIN.

ORDERED BY: MIKE EGLITE
4231 POPLAR DRIVE
DELAVAN, WI 53115

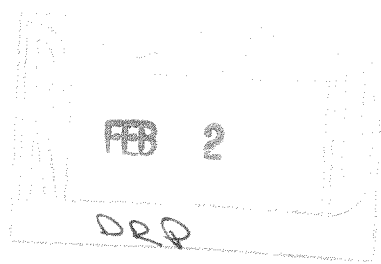

NOTE: BEARINGS ARE REFERENCED TO
EXISTING SURVEY RECORDS.

N



SCALE 1"=20'

LEGEND

- ⊘ - IRON PIPE FOUND
- - 1" DIA. IRON PIPE SET
- BE - BASEMENT ENTRY
- WP - WOOD PORCH
- () - RECORDED AS

I HEREBY CERTIFY THAT I HAVE SURVEYED THE ABOVE DESCRIBED PROPERTY AND THAT THE ABOVE MAP IS A TRUE REPRESENTATION THEREOF AND SHOWS THE SIZE AND LOCATION OF THE PROPERTY, ITS EXTERIOR BOUNDARIES, THE LOCATION OF ALL VISIBLE STRUCTURES AND DIMENSIONS OF ALL PRINCIPAL BUILDINGS THEREON, BOUNDARY FENCES, APPARENT EASEMENTS, ROADWAYS AND VISIBLE ENCROACHMENTS, IF ANY, TO THE BEST OF MY KNOWLEDGE AND BELIEF.

THIS SURVEY IS MADE FOR THE USE OF THE PRESENT OWNERS OF THE PROPERTY, AND ALSO THOSE WHO PURCHASE, MORTGAGE, OR GUARANTEE THE TITLE THERETO WITHIN ONE (1) YEAR FROM DATE HEREON.

David F. Abell

DAVID F. ABELL
WISCONSIN REGISTERED LAND SURVEYOR, S-1596

June 8, 2003

DATE: _____ JOB NUMBER - 03079
NOTE: THIS IS NOT A CERTIFIED COPY UNLESS SEALED.

FLAD-119

216-3685