

TOM TIDWELL  
600 SUE ANN DR.  
LAKE GENEVA WI. 53147

# PLAT OF SURVEY

J.K. SURVEYING INC.  
N3705 WILLOWBEND LANE  
LAKE GENEVA, WI, 53147  
262-248-3697

- OF -

LOT 2 OF CERTIFIED SURVEY MAP NO. 2473, A PARCEL OF LAND LOCATED IN THE SOUTHWEST 1/4 OF THE SOUTHWEST 1/4 OF SECTION 25,  
T2N, R16E, WALWORTH COUNTY, WISCONSIN AND BEING IN A DIVISION OF LOT 3 OF CERTIFIED SURVEY MAP NO. 2420.

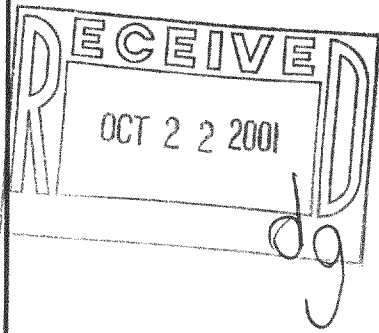

N 89°50'48" W 332.96'  
( N 89°51'57" W 332.97' )

LOT 2  
5.00 acres

655.64'  
S 0°00'00" E

622.90'

622.57'

( N 0°08'10" E 655.65' )  
N 0°07'39" E  
655.53'

NORTH

IRON PIPE FOUND 0.26'  
SOUTH OF R-O-W ON LINE

IRON PIPE FOUND 0.04'  
SOUTH OF R-O-W ON LINE

SOUTHWEST CORNER  
SECTION 25-2-16

996.47'

32.74'

S 89°51'57" E  
331.50'

S 89°51'57" E 331.50'

( 331.42' )

SOUTH 1/4 CORNER  
SECTION 25-2-16

32.96'

1328.00'

BAILEY ROAD ( 66' WIDE )

( ) = recorded as

□ = found iron bar

○ = found iron pipe

● = set iron pipe

■ = set iron bar

SCALE 1" = 60'

JOB # 01-419

TAX ID # FA247300002

COMPARE LEGAL DESCRIPTION ABOVE AND DRAWING WITH DEED. FOR BUILDING RESTRICTIONS AND  
EASEMENTS NOT SHOWN, REFER TO DEED, ABSTRACT SOURCES AND LOCAL MUNICIPAL CODES. NOTIFY  
THE SURVEYOR IMMEDIATELY OF ANY DISCREPANCY.

"I hereby certify that I have surveyed the above described property and that  
the above map is a true representation thereof and shows the size and  
location of all visible structures, apparent easements and encroachments  
if any."

This survey is made for the present owners of the property, and those who  
purchase, mortgage, or guarantee the title thereto, within one year from  
the date hereof.

DATED THIS 2<sup>TH</sup>, DAY OF OCTOBER 2001.

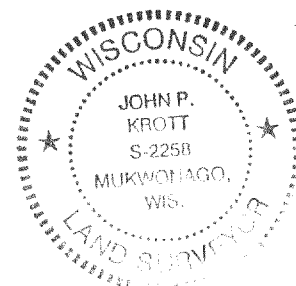

*John P. Krott*  
JOHN KROTT S - 2258  
Wisconsin Registered Land Surveyor  
( original if signed in red )