

FLAT OF SURVEY
NW 1/4 OF THE NE 1/4
SECTION 15, TOWN 2 NORTH, RANGE 16 EAST
WALWORTH COUNTY, WY

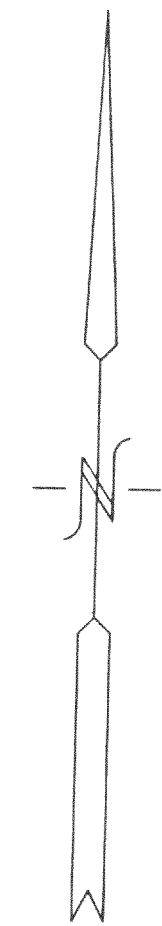

WISCONSIN COORDINATE SYSTEM
SOUTH ZONE NGVD 1927
EAST LINE NW 1/4 BEARS
N 01°24'17" W

LEGEND

- - FOUND IRON REBAR STAKE
- ⊕ - SOIL BORING
- (XXX) - RECORDED AS

I HEREBY CERTIFY THAT THE ABOVE DESCRIBED PROPERTY HAS BEEN SURVEYED UNDER MY DIRECTION AND THAT THE ABOVE MAP IS A TRUE REPRESENTATION THEREOF AND SHOWS THE SIZE AND LOCATION OF THE PROPERTY AND ITS EXTERIOR BOUNDARIES. THIS SURVEY IS MADE FOR THE USE OF THE PRESENT OWNERS OF THE PROPERTY, AND ALSO THOSE WHO PURCHASE, MORTGAGE, OR GUARANTEE THE TITLE THERETO WITHIN ONE YEAR FROM THE DATE HEREOF.

DATED: 6-30-2000

Peter S. Gordon
PETER S. GORDON R.L.S. 2101

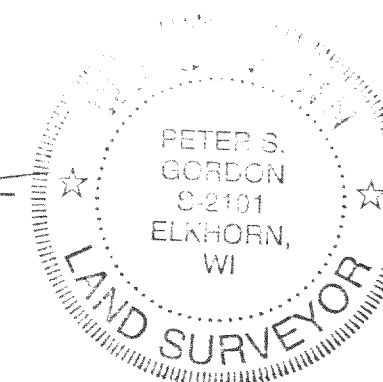

RECEIVED
JUL 13 2000

FARRIS, HANSEN & ASSOCIATES, INC.
ENGINEERING - ARCHITECTURE - SURVEYING
7 RIDGWAY COURT P.O. BOX 437
ELKHORN, WISCONSIN 53121
OFFICE: (262) 723-2098 FAX: (262) 723-5886

REVISIONS

PROJECT NO.
5398
DATE:
06/30/00
SHEET NO.
1 OF 1